

Meeting Rooms Floor Plans*

2nd Floor

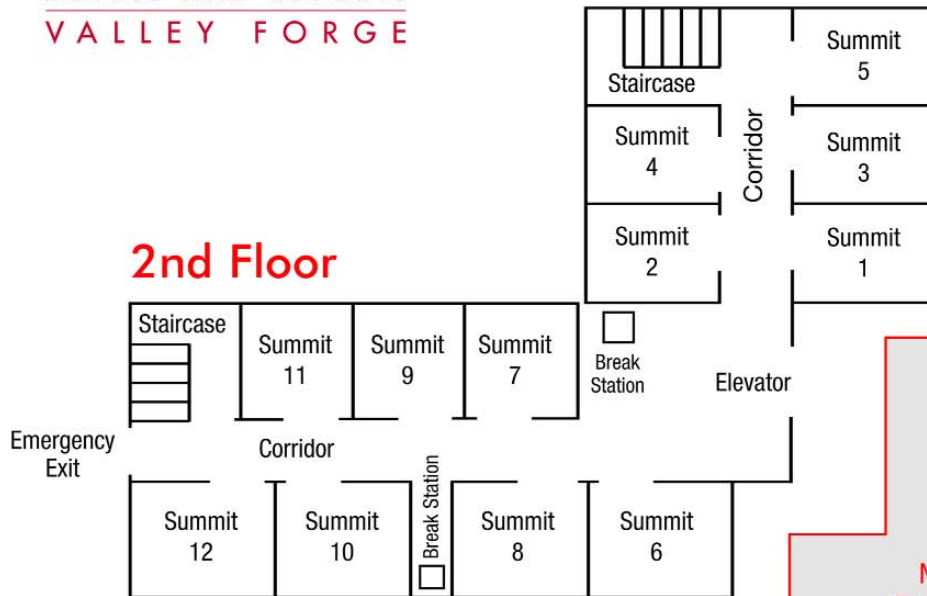

Lobby Level

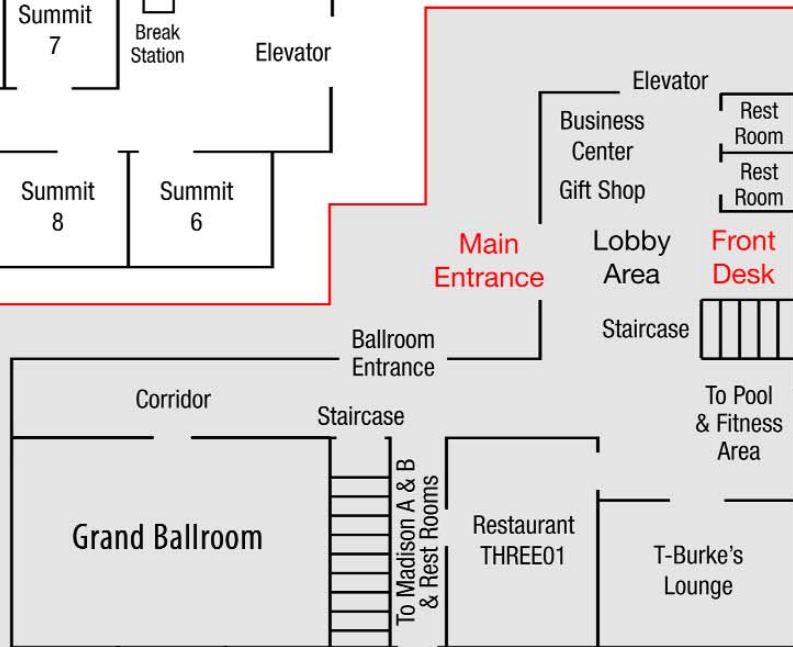

Lower Level

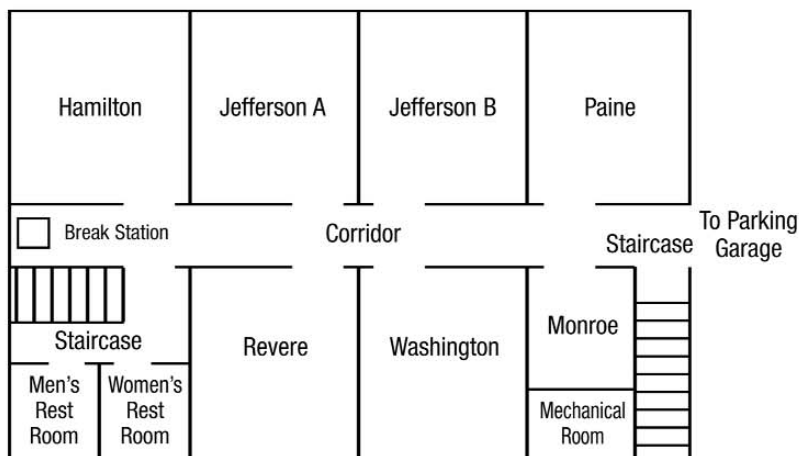

INVEST



American Planning Association
Pennsylvania Chapter

Making Great Communities Happen

2009 ANNUAL CONFERENCE

October 4-6, 2009

Dolce Valley Forge
King of Prussia, PA
www.planningpa.org

- ▶ **Earn up to 13.5 CM credits** including Law and Ethics requirements
- ▶ **Pitkin Lecture with Jeremy Nowak**, The Reinvestment Fund
- ▶ **Opening Session with Tim Beatley**, University of Virginia School of Architecture
- ▶ **Plenary Session with Sandy Wiggins**, Consilience, Inc.
- ▶ **Two and a half days** of Educational Sessions
- ▶ **Welcome Reception** at the Valley Forge National Park Welcome Center
- ▶ **Monday Evening Reception** featuring The Flying Mangos
- ▶ **PA Chapter Annual Awards, Posters** Sessions and Mobile Workshops
- ▶ **PA Chapter of APA Golf Outing** at Raven's Claw Golf Club
- ▶ **New Green Meetings Initiatives**



▶ 100% ONLINE

NEW 100% ONLINE OPTIONS AT CAL U TO ADVANCE YOUR EDUCATION AND PROFESSIONAL DEVELOPMENT

In just 12-24 months*, you will prepare yourself for an exhilarating career in the ever-evolving fields of tourism research, planning and development. We realize that busy schedules may not allow for the completion of the entire master's program. That is why we are proud to offer the 18 credit Post-Bachelor's Certificate, allowing you to invest in your professional development without commitment to the entire program. Of course, upon completion of the certificate program, there is the option for you to apply those credits toward the completion of the revised 30-credit master's program. Cal U is an affiliate member of the World Tourism Organization's Education Council, which is comprised of worldwide leading tourism education institutions. This means you get an education of the highest quality, from one of the world's leading tourism education institutions. At Cal U, you'll find the curriculum unique, the flexibility a relief and the coursework captivating. To learn more about Cal U's Post-Bachelor's Certificate program and the newly revised Master of Arts Tourism Planning and Development program, check us out at www.cup.edu/go/tourism or call 866-595-6348.

*The programs are designed for a student to complete in 12 months for the Post-Bachelor's Certificate and 16-24 months for the Master of Arts in Tourism Planning and Development Program. Changes to the proposed schedule can lengthen or shorten the program's duration.



California University of Pennsylvania
250 University Avenue
California, Pennsylvania 15419



California University of Pennsylvania's Global Online program offers a high-quality educational experience that is tailored to fit into your schedule. It is 100% online and has no classroom requirement. This gives you the freedom and flexibility to complete your academic program, gain valuable experience in the marketplace and live your life, all at the same time.





PLANNING COMMITTEE

COMMITTEE CO-CHAIRS:

Graciela Cavicchia, AICP

The Reinvestment Fund

Brian O'Leary, AICP

Montgomery County Planning Commission

David Ward, AICP

Chester County Planning Commission

COMMITTEE:

David Babbitt, AICP

David C. Babbitt & Associates LLC

Ronald Bednar, AICP

State of Pennsylvania

Richard Bickel, AICP

Delaware Valley Regional Planning Commission

Brendan Cotter

Delaware County Planning Department

Martha Cross, AICP

Melvin Design Group

Dottie Ives Dewey, PhD, AICP

West Chester University

Angela Dixon, AICP

Hurley Franks & Associates

Justin Dula, AICP

Delaware County Planning Department

Jennifer Duval, AICP

Jacobs

Susan Elks, AICP

Chester County Planning Commission

Walter Evans, AICP

Walter C. Evans & Associates, Inc.

Ben Ginsberg, AICP

Dennis Glackin, AICP

Glackin Thomas Panzak

Alan Higgins

Delaware County Planning Department

Deborah Howe, FAICP

Temple University

John Kennedy, AICP

Kennedy & Associates, LLC

John Landis

University of Pennsylvania

Robert O'Leary

Tredyffrin Township Planning Commission

John E. Pickett, PE, AICP

Delaware County Planning Department

Susan Phillips, PE, PTOE, AICP

CMX Engineering

Rebecca Ross, AICP

Delaware County Planning Department

Joseph Russo

Delaware County Planning Department

Heather Sherk, AICP

Traffic Planning and Design, Inc.

Michael Stokes, AICP

Montgomery County Planning Commission

Tracy Tackett

CH Planning

Cheryl Graff Tumola

Radnor Township Comprehensive Plan
Implementation Committee

John Weller, AICP

West Whiteland Township

Darlene Gallant Wynne, AICP

Montgomery County Planning Commission

Sarah Galbraith, CMP

PA Chapter Administrator



WELCOME TO VALLEY FORGE...

2009 PA Chapter of the American Planning Association Annual Conference

ON BEHALF OF THE 2009 CONFERENCE COMMITTEE of the Pennsylvania Chapter of the American Planning Association, we welcome you to Valley Forge.

The Delaware Valley exemplifies the theme of this year's conference: **Investing in a Sustainable Future**. Smart Growth initiatives, including cooperative planning ventures, smart transportation improvements, innovative affordable housing and economic development tools, and green technology, have emerged as critical issues facing Pennsylvania. The sessions and mobile workshops offered by this year's conference serve as a challenge to planners across the Commonwealth as we work towards planning practices that prepare communities for a sustainable future.

Going Green. We are a Green conference. Use of recycled products, local foods, water coolers, and a significant reduction in waste materials sets the standard for local municipal practices as well as for future conferences. We hope you will join us in reducing waste at the conference. Reduction in materials and energy will save both money and the environment.

We invite you to experience the richness of our history, the birth place of our Nation, and encourage you to immerse yourself in the Conference itself, which offers a wide range of workshops and events to increase your knowledge and awareness of contemporary planning practices and policies.

Sincerely,

Co-Chairs of the 2009 Conference Committee:

Graciela Cavicchia, AICP

Brian O'Leary, AICP

David D. Ward, AICP

Places



People



Planning / Environmental Excellence



Pennsylvania



PARSONS BRINCKERHOFF

www.pbworld.com

**Community & Regional Planning • Alternative Analyses
Transportation Planning • Public Involvement • Land Use Planning
Environmental Studies & Permits**

4 Penn Center
1600 JFK Boulevard
Suite 700
Philadelphia, PA 19103
215-561-1900

3314 Market Street
Suite 204
Camp Hill, PA 17011
717-412-4795

Four Gateway Center
Suite 1305
Pittsburgh, PA 15222
412-281-9900

Proud to Support the APA Pennsylvania Chapter 2009 Conference



Since 1946, McCormick Taylor's community of transportation engineers, planners, environmental specialists and communication experts have responded to our clients' most challenging and complex projects by saying, "Yes. We can do that."

Yes. We can do that.



Our planning services include:

- Community & regional comprehensive planning
- Transportation corridor land use planning
- Transit-friendly development planning
- Urban design studies
- Landscape architecture
- Environmental studies
- Geographic information systems & cartography
- Visioning & community consensus building

McCormick
Engineers & Planners
Since 1946 **Taylor**

Two Commerce Square, 2001 Market Street, 10th Floor
Philadelphia, PA 19103

10 offices in PA, NJ, MD, DE, VA & OH

www.mccormicktaylor.com





Mackin

Navigating Projects from Vision to Reality

Planning Services

- › Comprehensive Planning
- › Transportation Corridor Planning
- › Recreation, Parks, & Open Space Planning
- › Ordinance Review & Development
- › Greenways Planning
- › Trail Feasibility Studies & Design



For more information please contact one of our offices or visit our website at
www.mackinengineering.com

Pittsburgh Office:

RIDC Park West
117 Industry Drive
Pittsburgh, PA 15275
Ph: 412.788.0472

New Cumberland Office:

Yellow Breeches Office Center
175 Limekiln Road; Suite 300
New Cumberland, PA 17070
Ph: 717.774.8900

Shaping Your Communities for Over 40 Years **{and counting}**

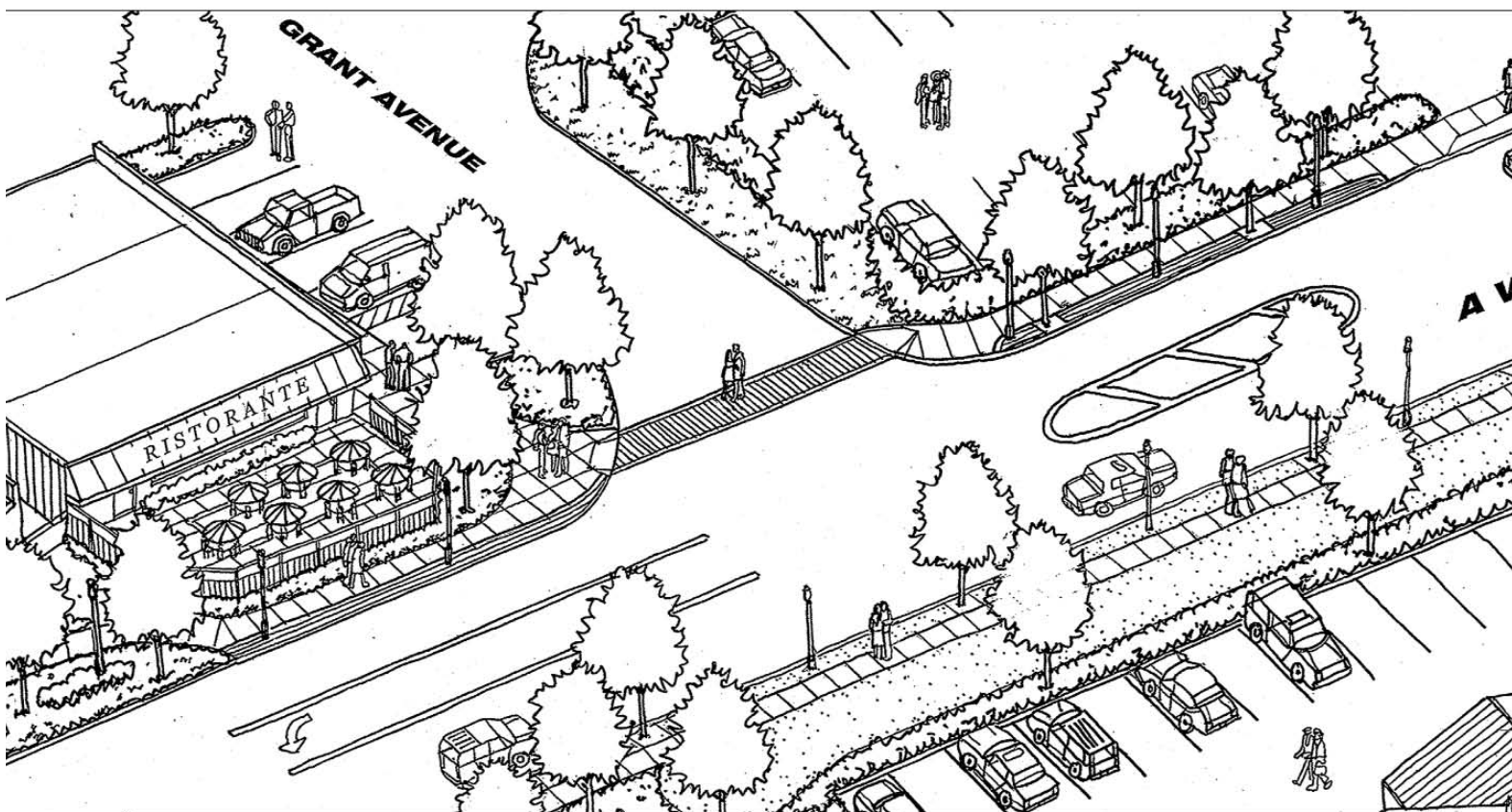

CMX professionals help implement your vision.

We recognize that communities face real challenges in stretching each dollar to gain the most value for their residents. By partnering with our clients and sharing their vision, CMX's professionals create a customized plan to bring your goals to fruition.

When you're ready to enlist the expertise of a firm that's passionate about what they do and has the local knowledge and experience to efficiently and effectively bring your vision to life, CMX is ready to be your partner. Call us today at 800.220.4055.

PUBLIC WORKS
WATER RESOURCES
ENVIRONMENTAL
TRANSPORTATION
SUSTAINABLE DESIGN
LAND DEVELOPMENT
BUILDING SERVICES
TELECOMMUNICATIONS
SPORTS ENGINEERING



www.cmxengineering.com

Geography & Planning Department

West Chester University

A Tradition of Excellence

We offer educational opportunities designed to meet the needs of
new planners and experienced planning professionals
Degree Programs include:

- ❖ Master of Science in Administration, Regional Planning Concentration
- ❖ Master of Arts, Geography
- ❖ Bachelor of Arts, Geography – Planning Concentration
- ❖ Certificate in Geographic Information Technologies

Resources for Learning:

Three GIS Labs

Internship Program

Service Learning Opportunities

Late Afternoon and Evening Courses

Graduate Assistantships

Project-based Learning

Study Abroad

Extensive Alumni Network



Parkesburg Parking Study

For more information please contact:
Dr. Joan Welch, Chair or
Dr. Dorothy Ives Dewey
Geography & Planning Department
Ruby Jones Hall 103
West Chester University
West Chester, PA 19383
610-436-2343
jwelch@wcupa.edu
divesdewey@wcupa.edu



URBAN DESIGN + PLANNING

UNIQUE INSIGHT INTO DEVELOPING EFFECTIVE SOLUTIONS

Through innovative design, HNTB strives to balance human needs and cultural influences with the natural world. The result is an artistic expression of the human spirit conveyed in form, scale, color and texture and fitted into the character of each site. The foundations of our approach are an appreciation for quality and an understanding of the timelessness of sophisticated design.

For more than 90 years, HNTB has been shaping the environment with our mix of urban planners, landscape architects, transportation planners, environmental planners and scientists. Together, they provide a multi-disciplined team that is well positioned to lead communities in new directions using 21st Century planning practices and policies. **BUILDING STRONGER COMMUNITIES BEGINS HERE.**



- *Community Planning*
- *Urban Design & Landscape Architecture*
- *Transportation Planning*
- *Environmental Planning*

Peter J. Denitz, AICP, PP
Associate Vice President

HNTB Corporation
1628 John F. Kennedy Blvd.
8 Penn Center, 7th Floor
Philadelphia, PA 19103

Tel: (215) 282-1151
Email: pdenitz@hntb.com
www.hntb.com

HNTB



MANY THANKS...
to our generous sponsors for their support of the 2009 Annual Conference!

Please consider these companies and organizations when you are seeking partners and consultants for your projects.

Diamond Sponsors

California University of Pennsylvania
Governor's Center for Local Government Services, PA DCED
Temple University Ambler College,
Department of Community & Regional Planning

Platinum Sponsor

URS Corporation

Silver Sponsors

Delaware Valley Regional Planning Commission
Herbert, Rowland & Grubic, Inc.
IUP Department of Geography and Regional Planning
J.P. Mascaro & Sons
Johnson Mirmiran & Thompson Inc.
Kaplin Stewart Meloff Reiter & Stein, P.C.
Kennedy & Associates
University of Pennsylvania School of Planning
Wallace Roberts & Todd, LLC

Exhibitors as of September 18

4ward Planning LLC
Brandywine Conservancy
California University of Pennsylvania
Gannett Fleming, Inc.
Governor's Center for Local Government Services
Johnson Mirmiran & Thompson Inc
Mackin Engineering
Main Street GIS, LLC
Maser Consulting P.A.
Michael Baker Jr Inc.
PA Department of Conservation and Natural Resources
Parsons Brinckerhoff
Pennsylvania Natural Heritage Program
Spotts, Stevens and McCoy, Inc.
Temple University Ambler College, Department of Community & Regional Planning
Trans Associates
URS Corporation
U.S. Census Bureau
Wallace Roberts & Todd, LLC
West Chester University–Geography and Planning Department



SUPPORT THE NEXT GENERATION OF PLANNERS!

THE PRICE OF EDUCATION, along with everything else, is rising rapidly. Students in planning education programs are working even harder not only to succeed academically, but to find the resources to cover the cost of their education. **YOU CAN HELP!**

Support the PA Chapter **Scholarship funds – the Spaulding Fund and the Pitkin Fund** – with three opportunities at this year's conference:

- ▲ **At conference registration**, choose to make a tax deductible contribution to the scholarship fund. Simply drop your donation in the scholarship box.
- ▲ **Following Monday's evening reception**, join all your old and new friends at Kildare's Irish Pub for drinks and snacks and a rousing match of the popular pub trivia game Quizzo! Test your brainpower and compete for prizes with a few rounds of Quizzo, or just socialize and enjoy the surroundings. The admission price includes two drink tickets and complimentary snacks. The proceeds will benefit both funds.



- ▲ **While you are at the conference, please be generous** with your purchase of tickets for the raffle auction. Generous donors will contribute everything from weekend getaways to gourmet food baskets to art. Counties contribute baskets filled with wonderful and diverse offerings of their locale. Tickets will be on sale during registration, meals, and breaks. Winners will be selected at the conference and announced during the Tuesday lunch. You will be supporting a worthwhile cause, and you may go home with some wonderful prizes!

URS

www.urscorp.com

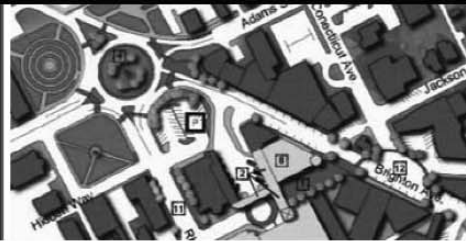

URS is a leader in planning, combining the talents of our planners, architects, and engineers into a unified team to build sustainable environments.

Redevelopment planning
Comprehensive plans
Design guidelines
Transportation planning
Zoning and development codes
Multi-municipal planning
Public involvement
Transit oriented development

CREATING PLACES



CONNECTING COMMUNITIES



For more information, please contact:

Marian Hull, AICP/PP
215.940.9270
marian_hull@urscorp.com

Keith Johnson
412.503.4700
keith_johnson@urscorp.com



TRAFFIC PLANNING AND DESIGN, INC.

WWW.TRAFFICPD.COM

TPD@TRAFFICPD.COM



Est. 1989

Corridor/Access Management Studies

Transportation Impact Fee Studies

Transportation Master Plans

Traffic Calming Studies and Design

Streetscapes/Bicycle and Pedestrian Facilities

Municipal Transportation Engineering Services

Bridge/Roadway/Traffic Signal Design and Construction Services

Pottstown, PA

Lehigh Valley, PA

Harrisburg, PA

Pittsburgh, PA

Camden, NJ

leadership.

We challenge organizations to be innovative.

GSPIA, one of the nation's leading graduate schools for public and international affairs, supports government and nonprofit agencies in their mission to be accountable in the delivery of just and equitable services.

Through education, research, and practical application, GSPIA graduates are well prepared to creatively guide the growth and redevelopment of urban, suburban, regional, and rural communities.

GSPIA University of Pittsburgh
Graduate School of Public
and International Affairs

Celebrating 50 Years of Education,
Research, and Public Service

www.gspia.pitt.edu

A SUSTAINABLE
FUTURE
TAKES COMPREHENSIVE
PLANNING
TODAY

**MULLIN &
LONERGAN
ASSOCIATES**
INCORPORATED

www.MandL.net	3909 Hartzdale Drive, Suite 901
Community Development	Camp Hill, PA 17011-7838
Housing & Economic Development	717-731-1161
Comprehensive Planning & Zoning	800 Vinial Street, Suite B-141
Rehab/Reuse Studies	Pittsburgh, PA 15212-5128
Downtown & Neighborhood Revitalization	412-323-1950





Assisting Pennsylvania communities with critical water planning issues

- Strategic Planning for Water Supply & Wastewater Management
- Onsite & Decentralized Wastewater Treatment Systems Management Planning
- Wetlands Delineations
- Stormwater Management Planning
- GIS for Utilities Mapping & Infrastructure Management



CET ENGINEERING SERVICES

Harrisburg
717.541.0622

Huntingdon
814.643.8260

Trevoze
215.245.2264

www.cet-inc.com

Clear Solutions to Complex Problems

imagination | innovation | involvement | impact

**sustainable solutions through green planning,
design and implementation**

Land Use Planning

Urban Revitalization

Transportation Planning & Design

Environmental/Facilities Services

Construction Management

Transit Planning & Design

Landscape Architecture

Information Technology

Structural Engineering

Water/Wastewater

Traffic Engineering

Water Resources

Surveys

GIS



Philadelphia
1.800.266.5488

York

Pittsburgh
www.jmt.com



Indiana University of Pennsylvania

DEPARTMENT OF GEOGRAPHY
AND REGIONAL PLANNING

IUP is the only university in the Pennsylvania State System of Higher Education to offer an undergraduate degree in Regional Planning.

IUP's Bachelor of Science in Planning offers two areas of concentration:

- Land Use and GIS
- Environmental Planning

Over 90 percent of program graduates over the last five years have been placed in graduate programs or have found employment in industry or government.

www.iup.edu/geography

724-357-2250



beyond expectations



ABOUT THE CONFERENCE

About the Sessions and Certification Maintenance Credits:

- ▲ **Application has been made to APA** for approval for Certification Maintenance (CM) credits for all of the general sessions and most of the workshops at this year's conference. **A total of 13.5 CM credits may be earned**, depending on workshops chosen. Both Law and Ethics CM credits are offered.
- ▲ **The list of approved sessions will be posted** on the PA Chapter website, www.planningpa.org, once approval is received from APA.
- ▲ **Courses approved by APA for CM credit** are also accepted by the Commonwealth of PA for landscape architect continuing education.
- ▲ **Any session may be cancelled or rescheduled** because of low registration or other unforeseen circumstances. Changes or cancellations will be noted in the final program that will be distributed at the conference.
- ▲ **Conference materials will be provided this year in printed form and on flash drives** sponsored by URS Corporation. We recommend you bring a briefcase or messenger bag if you would like for conference materials.
- ▲ **The PA Chapter of the American Planning Association is not responsible** for the materials or opinions of the speakers you will hear.

Conference Etiquette:

- ▲ The **Dress Code** for the conference is business casual attire. Plan to be comfortable while recognizing that this is a learning environment.
- ▲ Please place **cell phones** and other devices that make noise in "silent" mode during sessions. If you must take a call, we ask that you exit the session as unobtrusively as possible and take the call in the corridor.
- ▲ Please be considerate of other conference participants who may have **allergies or sensitivities to fragrances**. If your fragrance is strong, please consider using less of it, or not using it during the day.
- ▲ **Room temperatures** are difficult to regulate. We recommend you dress in layers so you can add or remove a layer for your personal comfort.
- ▲ The conference is a **non-smoking event**. Smoking is not permitted at any conference event, including mobile workshops.

Greening the Annual Conference:

In keeping with this year's conference theme "**Investing in a Sustainable Future**," the conference committee has established a number of sustainability initiatives to reduce our impact on the environment:

- ▲ **Purchase products** made from recycled, recyclable, and rapidly renewable materials.
- ▲ Work with the hotel and caterer to **purchase local foods** and plan a seasonal menu.
- ▲ Prominent on-site effort to **increase recycling** of cardboard, paper, plastic bottles, and cans.
- ▲ **Donate excess food** to a food rescue agency.
- ▲ Encourage exhibitors to **use products made from recycled**, recyclable, and rapidly renewable materials.
- ▲ **Water coolers** in the meeting rooms in lieu of bottled water breaks.
- ▲ Selection of a hotel with a **strong green initiative**, including significant efforts to reduce waste and energy consumption, a linen reuse program, and an on-site "green team."

Be a part of Greening the Annual Conference by participating in the following ways:

- ▲ **Participate in the hotel's linen reuse program** (sheets and towels). Information can be found in the guest rooms.
- ▲ Register for the conference online to **save postage and paper costs**.
- ▲ **Consider public transportation** and carpooling.
- ▲ **Return waste paper** to conference registration for **recycling**.
- ▲ **Use your eco-friendly Flash Drive!** The conference flash drives do not contain any toxic materials such as lead, mercury, hexavalent chromium, PBB or PBDE. These toxins have been identified as the most common and harmful toxins in electronic components. The use of lead-free solders in eco friendly USB flash drives allows the drives to decompose without contaminating water with toxic lead.

About the Final Program:

The 2009 Annual Conference Final Program is printed on Roland Opaque30 Smooth Bright White 70# and contains FSC certified 30% post-consumer fiber. This paper is EcoLogo and FSC Mixed Sources certified and is manufactured using renewable biogas energy. Roland papers are produced by Cascades, an environmentally friendly company whose paper production practices save 30 million trees a year.



*Please help us close the loop
and recycle this publication.*



THE
WAETZMAN
PLANNING
GROUP

SMART PLANNING FOR
PENNSYLVANIA MUNICIPALITIES

THE WAETZMAN PLANNING GROUP

1230 County Line Road

Bryn Mawr, PA 19010

610 527-0600 610 527-0445 FAX

800 669-5202

wpg@waetzmanplanning.com

Land Use, Zoning & Development Law

Kaplin Stewart

Attorneys at Law

910 Harvest Drive

Blue Bell, PA 19422

610.260.6000

www.kaplaw.com

Offices in PA and NJ

Enhancing the Quality of Life

Our work enhances the quality of life for our clients, our employees, and the people touched by our work. It touches this generation and future generations. **We celebrate the earth everyday** with our approach to operations and the application of green solutions and sustainable designs.

Sustainable Solutions since 1932

- Municipal Engineering and Planning
- Site Engineering and Infrastructure
- GeoEnvironmental Services
- Facilities Engineering
- Civil Engineering
- Water and Wastewater
- Indoor Environmental Quality



SPOTTS | STEVENS | MCCOY

ssmgroup.com



BUILDING INSPIRED COMMUNITIES



We are dedicated to establishing real diversity within neighborhoods by providing a broad range of housing types and price levels in an effort to bring people of all ages, cultures, and incomes into daily interaction. The resulting strengthening of personal and civic bonds contributes to the creation of an authentic community.



THE HANKIN GROUP™

610.458.1900

www.hankingroup.com

DISTINCTIVE
RESIDENTIAL
PROPERTIES



**Kennedy
& Associates**

PLANNERS AND LAND USE CONSULTANTS

- ◆ Site Analysis and Feasibility
- ◆ Master Planning
- ◆ Site Planning
- ◆ Zoning and Land Use Policy
- ◆ Parking Analysis
- ◆ Graphic Exhibits
- ◆ Project Management

DESIGNING GREAT COMMUNITIES SINCE 1990

29 MAIN STREET HARLEYSVILLE, PA 19438

TEL: 215.513.1720 FAX: 215.513.1721 NET: LANDPLAN.COM



CONFERENCE AT-A-GLANCE

SUNDAY, OCTOBER 4, 2009

10:30a	PA Chapter of APA Open Golf Outing at Raven's Claw Golf Club
1:00p – 8:00p	Registration Open
1:00p – 5:00p	PMPEI Planning Officials Training
3:30p – 5:00p	Legislative Committee Meeting
3:30p – 5:00p	CONCURRENT WORKSHOPS – SERIES A
5:00p	Transportation pickup for Guided Tour
5:00p – 6:00p	Professional Development Committee Meeting
5:00p – 6:30p	Board of Directors Dinner
5:30p – 6:30p	Guided Tour of Valley Forge National Historical Park
6:15p – 8:30p	Transportation available for Welcome Reception
6:30p – 8:30p	Welcome Reception at Valley Forge National Historical Park Welcome Center

MONDAY, OCTOBER 5, 2009

7:00a – 5:00p	Registration Open
7:00a – 8:00a	Continental Breakfast in Exhibit Hall
7:00a – 5:00p	Exhibit Hall Open
8:00a – 9:00a	Opening Keynote: Tim Beatley, University of Virginia School of Architecture
9:00a – 12:00p	Mobile Workshops
9:15a – 10:30a	CONCURRENT WORKSHOPS – SERIES B
10:30a – 11:00a	Refreshments with the Exhibitors
11:00a – 12:15p	CONCURRENT WORKSHOPS – SERIES C
12:30p – 2:00p	Pitkin Luncheon and Lecture: Jeremy Nowak, President, The Reinvestment Fund
2:00p – 5:00p	Mobile Workshops
2:15p – 3:30p	CONCURRENT WORKSHOPS – SERIES D
3:30p – 4:00p	Refreshments with the Exhibitors
4:00p – 5:30p	CONCURRENT WORKSHOPS – SERIES E
5:45p – 6:30p	SE Section Reception (section event only)
6:30p – 8:30p	Evening Reception at Dolce Valley Forge
9:00p – 11:00p	Quizzo Night at Kildare's Irish Pub





TUESDAY, OCTOBER 6, 2009

6:30a – 8:00a	Fun Run, Valley Forge National Historical Park
8:00a – 5:00p	Registration Open
8:00a – 4:00p	Exhibit Hall Open
8:00a – 9:00a	Continental Breakfast in Exhibit Hall – Meet and Greet with Board of Directors
9:00a – 10:00a	Plenary Session: Sandy Wiggins, Principal, Consilience Inc.
10:00a – 10:30a	Refreshments with the Exhibitors
10:30a – 11:45a	CONCURRENT WORKSHOPS – SERIES F
12:00p – 2:00p	Annual Meeting, Awards Program and Luncheon
2:15p – 3:30p	CONCURRENT WORKSHOPS – SERIES G
3:30p – 4:00p	Refreshments with the Exhibitors
4:00p – 5:30p	CONCURRENT WORKSHOPS – SERIES H



Environmental Consulting, LLC

A PA Certified DBE Firm providing the following services:

-  NEPA Documents
-  Socioeconomic Studies
-  Farmland Analysis/ALCAB Coordination
-  Public and Agency Involvement
-  Natural Resource Investigations/Permitting

*Please Contact Us Below
To Learn How We Can Fulfill Your
DBE Requirements*

Katherine M. Farrow
President

524 Pugh Road
Wayne, PA 19087
P: 610.909.2023

E: kfarrow@lotusenvironmental.com

www.lotusenvironmental.com



WOODROW & ASSOCIATES

Municipal / Civil
Consulting Engineers

Spring House Corporate Center
323 Norristown Road
Suite 100
Ambler, PA 19002

PHONE: 215-542-5648 FAX: 215-542-5679



HRG
Herbert, Rowland & Grubic, Inc.
Engineering & Related Services

[BUILDING RELATIONSHIPS.
DESIGNING SOLUTIONS.]

Comprehensive Engineering and Related Services

Land Development • Water Resources • GIS
Transportation • Water & Energy • Environmental
Surveying • Financial • Electrical

717.564.1121 [phone] • www.hrg-inc.com

Wallace Roberts & Todd 
wrt design.com



Planning Urban Design Architecture Landscape Architecture



MEET THE ECO-HAPPY HYBRIDS OF SEPTA.

It's true. SEPTA can proudly say it has an impressive fleet of Hybrid Buses already out on the streets. But how do they work, you ask?

SEPTA's Hybrid Buses have the ability to refresh their own battery banks by using the normally wasted energy of braking. When the brakes are applied, the energy normally dissipated as heat in a conventional bus is redirected to charge the energy storage system installed on the roof to help power the bus. The introduction of these Hybrid Buses has allowed SEPTA to significantly reduce engine exhaust emissions and increase fuel economy.



But the Hybrid Buses are only one facet of all the good SEPTA is doing on the green front. Read on for more of SEPTA's campaign for emitting less bad stuff, and more feel-goodness.

WHY RIDING SEPTA ISN'T JUST ENVIRONMENTALLY CONSCIOUS, IT'S A NO-BRAINER.

SEPTA's standard buses deserve some energy-efficient love too. That's because all of SEPTA's standard buses use ultra clean low-sulfur fuel. And don't forget that taking any of SEPTA's travel options, from the subway to the trolleys, means a lighter carbon footprint for our area and the world.

It all adds up to arguably one of the most energy efficient large-city public transit systems in the nation. It's true – you literally go green by taking SEPTA.

STILL NEED CONVINCING? Check Out These Green Facts From the Clean Air Council:

- ▲ A big bus with just seven passengers is more fuel-efficient than the average car. A full bus? Six times more efficient. A full train, 15 times more efficient.
- ▲ If one in ten Americans used public transportation regularly, U.S. reliance on foreign oil could be cut by more than 40%.
- ▲ Public transit produces 95% less carbon monoxide (CO) per passenger mile than private vehicles.
- ▲ In Philadelphia, just 3.5% of CO emissions come from diesel-powered vehicles such as SEPTA's standard buses. Whereas gas-powered cars give off 63%.

Commuting On SEPTA Makes a World of Difference.

To Learn More About Riding on SEPTA,
Visit www.septa.org.



J. P. Mascaro & Sons
If it's service, it's us!

**ACTS
CLEAN
GREEN**

This Act "Clean & Green" initiative is consistent with our commitment to our customers, employees and the community.

Join us in our commitment to Act "Clean & Green" everyday.

To learn more go to www.jpмасcaro.com



PENN
lanning

RCS and A inc.
RICHARD C. SUTTER and ASSOCIATES, Inc.
Comprehensive Community Planners

35 YEARS OF EXCELLENCE
1974-2009

The Manor House, P.O. Box 564, Hollidaysburg, PA 16648
(814) 695-7577 Fax (814) 695-8652 planning@rcsanda.com



SEE YOU NEXT YEAR!

October 3-5, 2010
Lancaster Convention Center
and
Marriott Lancaster at
Penn Square

GLACKIN THOMAS PANZAK

LAND PLANNING
LANDSCAPE
ARCHITECTURE

Dennis F. Glackin, AICP, PP
Lisa L. Thomas, RLA, ASLA
Bernard S. Panzak, Jr., RLA

Paoli Executive Green 1
Suite 300
41 Leopard Road
Paoli, Pennsylvania 19301
610.408.9011
Fax: 610.408.9477
E-mail: plans@glackinplan.com

Make Great Places Artfully

Todd W. Bressi

Urban Design Place Planning Public Art

P.O. Box 32, Narberth PA 19072
610-667-2177 (o) 215-292-3642 (c)
placedesign@verizon.net
www.toddbressi.com



MURRYSVILLE, PA
724.327.3760

TUSTIN, CA
714.505.6360

ENCINITAS, CA
760.452.2300

PLANNING • DESIGN • ENVIRONMENTAL • GRAPHICS

WWW.TBPLANNING.COM

MainStreetGIS

Web GIS Hosting for
Cities and Towns

A complete, low-cost GIS solution for
Town, City, and County offices.

Web GIS - Desktop GIS - Kiosk GIS

Your own Web GIS site can be online in days!

www.mainstreetgis.com

www.mainstreetgis.com

1-888-827-6612

info@mainstreetgis.com

JACOBS™

Comprehensive Planning

Global experience
delivering sustainable
solutions to local projects

Offices Worldwide

1247 Ward Avenue, Suite 100
West Chester, Pennsylvania 19380-4259
U.S.A.
1.610.701.7000
Fax 1.610.696.3550

www.jacobs.com

DELAWARE VALLEY
dvrpc
REGIONAL
PLANNING COMMISSION

Leading the Way.

190 N. Independence Mall West
DVRPC, 8th Floor
Philadelphia, PA 19106-1520
Phone 215.592.1800 | Fax 215.592.9125
www.dvrpc.org

WE SEE THE FUTURE.

From infrastructure and transportation projects
to community development and redevelopment strategies
(and everywhere in between), we'll help you meet the
most unusual, intimidating challenges.

** Our new office in Delaware County is now open! **

CHPlanning
LIMITED

1429 WALNUT STREET, SUITE 1601 PHILADELPHIA, PA 215-751-1400
401 AVENUE OF THE STATES, SUITE 200 CHESTER, PA 610-872-7500

www.chplanning.com

WE'LL HELP YOU SEE YOURS.

ENVIRONMENTAL • MANAGEMENT

Planning for a Sustainable Future

Harrisburg
Chambersburg
Clearfield Lancaster
Philadelphia
Pittsburgh
State College
Valley Forge

www.gannettfleming.com
(717) 763-7211



Gannett Fleming

COME EARLY OR STAY LATE

AND MAKE IT A TRIP!

HERE ARE JUST A FEW THINGS TO DO IN THE AREA...
FOR MORE INFORMATION, SEE GOPHILA.COM AND VALLEYFORGE.ORG

SHOP FOR ONE-OF-A-KIND
ARTWORK AND ANTIQUES IN
NEW HOPE, PA AND LAMBERTVILLE, NJ

EXPERIENCE CASTLES FULL OF
TREASURES AT THE MERCER
AND FONTHILL MUSEUMS

ENJOY GOURMET DISHES
AND CHEAP EATS THROUGHOUT
THE DELAWARE VALLEY

HIKE OR BIKE THE
SCHUYLKILL RIVER,
VALLEY FORGE, &
PERKIOMEN TRAILS

SHOP THE LARGEST MALL ON THE
EAST COAST, THE PLAZA AND
COURT AT KING OF PRUSSIA

DOLCE VALLEY FORGE HOTEL
AND CONFERENCE CENTER

ENJOY DINNER AND A NIGHT ON THE
TOWN ON MAIN STREET IN MANYUNK

VIEW A WORLD CLASS
ART COLLECTION AT THE
BARNES FOUNDATION

TOUR THE PHILADELPHIA BREWING
COMPANY AND TASTE LOCAL BREWS

SEE THE FALL FOLIAGE AT
LONGWOOD GARDENS

VISIT BARTRAM'S GARDEN,
THE OLDEST BOTANICAL
GARDEN IN THE COUNTRY

EXPERIENCE THE LIFE AQUATIC
AT CAMDEN'S ADVENTURE AQUARIUM

TOUR WINERIES AND
TASTE LOCAL WINES
IN CHADDS FORD

STROLL THE SCENIC
CHRISTINA RIVERWALK

STAYING HERE:
THE DOLCE HOTEL IS OFFERING THE GROUP RATE FOR UP TO THREE
DAYS BEFORE AND THREE DAYS AFTER THE CONFERENCE

GETTING HERE:
THE DOLCE HOTEL IS LOCATED MINUTES FROM THE VALLEY FORGE EXIT OF THE PA TURNPIKE.
NEARBY NORRISTOWN (A SHORT SEPTA RT 99 BUS OR HOTEL SHUTTLE RIDE AWAY) IS SERVED
BY SEPTA'S REGIONAL RAIL R6 LINE FROM CENTER CITY PHILADELPHIA

FIND MORE OF OUR FAVORITE DESTINATIONS AND TRIP SUGGESTIONS ON THE CONFERENCE BLOG: APAPA09.ORG



Investing in a sustainable future

DETAILED SCHEDULE

SUNDAY

October 4, 2009

Tee Times
10:30a – 10:50a

PA Chapter of APA Open Golf Outing ***Raven's Claw Golf Club***

Located in Limerick Township, Montgomery County, Raven's Claw Golf Club is one of several new golf and residential communities in Southeastern Pennsylvania. The course has a variety of hole styles, many of which have been carved from rolling hills and mature wooded areas that require creative shot-making with stunning views. The course is ranked in the Top 10 in Pennsylvania by Golfweek magazine and on the Top New Courses in the United States by Golf Digest magazine.

The cost is \$70.00 which includes greens fees and a cart. Register for the golf outing on the conference registration form. You will be notified of your tee time. If you have a preferred foursome, please note that information on the registration form.

12:00p – 5:00p ➤

Exhibitor and Poster Session Setup

1:00p – 8:00p ➤

Registration Open

GRAND
BALLROOM
LOBBY

1:00p – 5:00p ➤

SUMMIT 10

PMPEI Planning Officials Training

Sponsored by PMPEI Certified Instructors

Unit 1: Basic Community Planning

PETER WULFHORST AICP, Penn State Cooperative Extension

CHARLES GUTTENPLAN: AICP, The Waetzman Planning Group

Unit 2: What Goes Into a Zoning Ordinance?

SHANNON ROSSMAN, Berks County Planning Commission

DAVID ZIPF, AICP, Bucks County Planning Commission

TINA FACKLER; AICP, Johnson, Mirmiran & Thompson, Inc.

Unit 3: Guiding Local Development

MARK VASOLI, ESQ., Hatboro, Pennsylvania

MICHAEL STOKES AICP, Montgomery County Planning Commission

Unit 4: Who's Who in Zoning Administration

LINUS FENICLE, ESQ., Reager & Adler

TRACY LEE TACKETT, AICP, CHPlanning Ltd

STANFORD LEMBECK, AICP, retired Penn State Cooperative Extension

3:30p – 5:00p ➤

WASHINGTON

Legislative Committee Meeting





Investing in a sustainable future

DETAILED SCHEDULE

3:30p – 5:00p ► CONCURRENT WORKSHOPS—Series A

JEFFERSON B

1. Planning and Zoning for Green Buildings

— 1.5 CM LAW*

EVANGELINE LINKOUS, Delaware Valley Regional Planning Commission

SHARI SHAPIRO, Esq., LEED AP, Obermayer Rebmann Maxwell & Hippel LLP

PAINE

2. Planning Ethics in Pennsylvania —

1.5 CM ETHICS*

MARK STIVERS, AICP, East Hempfield Township

ELAM HERR, PA State Association of Township Supervisors

JEFFERSON A

3. How Can Pennsylvania's Communities Plan for a Sustainable Future? — 1.5 CM*

DAVID ROUSE, AICP, ASLA, PP, LEED AP, Wallace Roberts and Todd

KIM WHEELER, AICP, PA Department of Community & Economic Development

ALEXANDER J. GRAZIANI, AICP, Smart Growth Partnership of Westmoreland County

SUMMIT 5

4. Successful Partnerships for Urban Renewal — 1.5 CM*

TROY TRUAX, AICP, Delta Development Group, Inc.

DEB ADAMIK, Main Street Gettysburg, Inc.

MERRY BUSH, Borough of Gettysburg

SUMMIT 8

5. Using Data and GIS to Target Neighborhood Stabilization Program Dollars — 1.5 CM*

IRA GOLDSTEIN, The Reinvestment Fund

MAGGIE MCCULLOUGH, The Reinvestment Fund

SUMMIT 6

6. ABC's of LEED for Homes and LEED for Neighborhoods — 1.5 CM*

THOMAS J. COMITTA, AICP, RLA, ASLA, Thomas Comitta Associates, Inc.

ELLEN HOLTZMAN, The Food Trust

5:00p ►

HOTEL LOBBY

5:00p – 6:00p ►

WASHINGTON

5:00p – 6:30p ►

NORTH PRIVATE

DINING ROOM

(WITHIN

RESTAURANT

THREE01)

Meet Transportation for the Guided Tour of Valley Forge National Historic Park

Professional Development Committee Meeting

Board of Directors Dinner



** These sessions have been submitted to APA for Certification Maintenance approval.*



5:30p – 6:30p ▶

Guided Tour of Valley Forge National Historic Park**

Originally established in 1893 as the first state park in Pennsylvania, Valley Forge National Historical Park is a 3,600-acre expanse of rolling hillsides that was incorporated into the National Park Service system on the United States Bicentennial, July 4, 1976. Through its collection of historical buildings, recreated encampment structures, memorials, museums, and recreation facilities, the National Park Service continues to promote, preserve, and interpret the site of George Washington and the Continental Army's winter encampment.

A guided tour of the park will be available prior to the reception. Meet at the Welcome Center reception desk at 5:30 p.m.

***Additional fee applies for the tour. Please see the registration desk to sign up.*

Transportation for the tour will be available between the Dolce Valley Forge Hotel and Valley Forge National Historical Park. Pick-up will be at the front of the hotel at 5:00p.

6:15p – 8:30p ▶
HOTEL LOBBY

Transportation available to and from the Dolce Valley Forge Hotel and Valley Forge National Historic Park

Hybrid Buses Provided by SEPTA



6:30p – 8:30p ▶

Welcome Reception at Valley Forge National Historical Park Welcome Center

Entertainment provided by Kaplin Stewart Meloff Reiter & Stein, P.C.

Featuring a Menu of Seasonal Local Foods

Join us for this year's opening reception held at the Welcome Center in the Valley Forge National Historical Park. Enjoy an enticing mix of seasonal local foods and drinks while socializing with new and old friends alike in the midst of exhibits that capture crucial moments of our nation's history. Engage in the site's history as you encounter George Washington or experience the tribulations of the Continental Army's winter encampment of 1777-78 with the film *Valley Forge: A Winter Encampment*.

A shuttle bus will make continuous loops to and from the Dolce Valley Forge Hotel and Valley Forge National Historical Park beginning at 6:15p. Meet the bus at the front of the hotel.



Investing in a sustainable future

DETAILED SCHEDULE

MONDAY
October 5, 2009

8:00a – 9:00a ▶
GRAND
BALLROOM

Opening Keynote Session — .75 CM*
*Sponsored by Governor's Center for
Local Government Services PA DCED*

7:00a – 5:00p ▶
GRAND
BALLROOM
LOBBY

Registration Open

TIMOTHY BEATLEY, PhD
**Teresa Heinz Professor of Sustainable
Communities, Department of Urban and
Environmental Planning, University of
Virginia School of Architecture**

7:00a – 5:00p ▶
GRAND
BALLROOM

Exhibit Hall Open

7:00a – 8:00a ▶
GRAND
BALLROOM

Continental Breakfast in Exhibit Hall
Sponsored by J.P. Mascaro & Sons
Visit exhibitors and poster sessions.
Support the scholarship fundraising raffle.



Timothy Beatley is the Teresa Heinz Professor of Sustainable Communities, in the Department of Urban and Environmental Planning, School of Architecture at the University of Virginia, where he has taught for the last eighteen years. His primary teaching and research interests are in environmental planning and policy, with special emphasis on coastal and natural hazards planning, environmental values and ethics, and biodiversity conservation. He has published extensively in these areas.

In recent years much of his research and writing has been focused on the subject of sustainable communities, and creative strategies by which cities and towns can fundamentally reduce their ecological footprints, while at the same time becoming more livable and equitable places. To this end, he is the recent author of The Ecology of Place (Island Press, 1997), with Kristy Manning, which reviews innovative local sustainability practice from around the country and provides practical guidance on creating more sustainable urban form, restorative local economies, and stronger communities. Beatley has recently returned from a year's research in Europe, specifically examining the experiences of some 30 cities, in twelve European countries. The findings of this study have been published in a recent book entitled Green Urbanism: Learning from European Cities (Island Press, 2000). He is also the author of a new book Native to Nowhere: Sustaining Home and Community in a Global Age (also published by Island Press, December, 2004).

Beatley holds a PhD in City and Regional Planning from the University of North Carolina at Chapel Hill.



** These sessions have been submitted to APA for Certification Maintenance approval.*

**PAINE****12. Town Centers in the Southeast Region — 1.25 CM***

DENNIS GLACKIN, AICP, PP, Glackin Thomas Panzak, Inc.

WENDI KAPUSTIN, AICP, Kaplin Stewart Meloff Reiter & Stein

STEPHEN M. SPAEDER, BPG Development Co. L.P.

ERIK HETZEL, AICP, LEED AP, Glackin Thomas Panzak, Inc.

JEFFERSON A**13. Energy and Climate Change: Planners' Role and Challenge — 1.25 CM***

CARRON DAY, AICP, Planning Associates LLC

NEALE MONTGOMERY, Esq., Pavese Law Firm

SUMMIT 5**14. Implementing LUTED Through a Project Prioritization Process: Case Study of North Central PA — 1.25 CM***

BRIAN FUNKHOUSER, Gannett Fleming, Inc.

DENNIS PUKO, Department of Community and Economic Development

WASHINGTON**15. Identifying Historic Housing Infrastructure — 1.25 CM***

CAROL LEE, PA Historical & Museum Commission

BILL CALLAHAN, PA Historical & Museum Commission

10:30a – 11:00a ▶**GRAND BALLROOM****Refreshments with the Exhibitors and Travel Time**

Visit exhibitors and poster sessions.

Support the scholarship fundraising raffle.

9:00a – 9:15a ▶ 15 Minutes Travel Time

9:00a – 12:00p ▶ Mobile Workshops

**OFF PREMISES
MEET IN LOBBY**

7-M. Small Town Revitalization Success Story — 3 CM*

RAY OTT, AICP, Ray Ott Associates

JOHN H. KENNEDY, AICP, Kennedy & Associates

**OFF PREMISES
MEET IN LOBBY**

8M. Trail Planning — 3 CM*

MICHAEL STOKES, AICP, Montgomery County Planning Commission

DAVID CLIFFORD, Montgomery County Planning Commission

RICHARD WOOD, Montgomery County Department of Parks and Heritage Services

9:15a – 10:30a ▶ CONCURRENT WORKSHOPS—Series B

JEFFERSON B

9. Improving Your Subdivision and Land Development Ordinance — 1.25 CM*

MICHAEL STOKES, Montgomery County Planning Commission

SUMMIT 6

10. Developing and Sustaining Communities for a Lifetime — 1.25 CM*

RACHEL B. COHEN, Third Age, Inc.

GABRIEL MANDUJANO, The Enterprise Center Community Development Corp.

SUMMIT 8

11. Using TDRs to Stretch Preservation Dollars and Achieve Smart Growth — 1.25 CM*

JOHN THEILACKER, AICP, Brandywine Conservancy

JOHN SNOOK, Brandywine Conservancy

ERIC JARRELL, Montgomery County Planning Commission





Investing in a sustainable future

DETAILED SCHEDULE

11:00a – 12:15p ➤

SUMMIT 8

CONCURRENT WORKSHOPS—Series C

16. Annual Update: Chapter Legislative Committee Activities, Required Training and MPC Rewrite Initiatives

RICHARD BICKEL, AICP, Delaware Valley Regional Planning Commission

STAN LEMBECK, AICP, Retired Professor, Pennsylvania State University

ELAM HERR, PA State Association of Township Supervisors

E.J. KNITTEL, PA State Association of Boroughs

JEFFERSON A

21. Implementing Complete Streets in Pennsylvania — 1.25 CM*

JOHN MADERA, AICP, Transportation Planning Consultant

JOHN NAWN PE, PTOE, FACFEI, Patrick Engineering, Inc.

GLENN C. ROWE, PE, PTOE, PennDOT Bureau of Highway Safety and Traffic Engineering

BRIAN D. HARE, PE, PennDOT Bureau of Design

WASHINGTON

17. Infill Philadelphia: Food Access — 1.25 CM*

MAMI HARA, ASLA, AICP, Wallace Roberts & Todd LLC and Community Design Collaborative

SUMMIT 5

22. Conservation Landscape Initiative: Promoting Sustainability of Special Places — 1.25 CM*

CINDY ADAMS DUNN, PA DCNR

LAUREN IMGRUND, PA DCNR

JEFFERSON B

18. Sustainability in Stormwater Management: Green Infrastructure from the City to the Urban Fringe — 1.25 CM*

WESLEY HORNER, AICP, Brandywine Conservancy

MICHELE ADAMS, PE, Meliora Environmental Design, Inc.

12:15p – 12:30p ➤

15 Minutes Travel Time

12:30p – 2:00p ➤

GRAND BALLROOM

Pitkin Luncheon and Lecture — .5 CM*

Sponsored by Temple University

PAINE

19. Imagine Regional Plans that Actually Work — 1.25 CM*

KIRK STONER, AICP, Cumberland County Planning Commission

CHRISTOPHER KNARR, AICP, RETTEW Associates, Inc.

"State of the Regional Economy"

JEREMY NOWAK, PhD
President and Chief Executive Officer,
The Reinvestment Fund

SUMMIT 6

20. Inclusionary Housing for Workforce Housing — 1.25 CM*

MICHAEL R. CARPER, Housing Development Corporation of Lancaster County

CYNTHIA FUHRER, Housing Development Corporation of Lancaster County

MARK STIVERS, AICP, East Hempfield Township

MARK HIESTER, Mount Joy Borough



The current economic downturn continues to affect communities across the country. While it has not been impacted as drastically as many other metropolitan regions, the Philadelphia region is experiencing serious economic challenges. These issues must be addressed with targeted efforts to ensure a successful recovery effort. An expert on urban affairs, Jeremy Nowak will discuss the state of the regional economy, its housing and job markets, and its infrastructure network. He will discuss (1) opportunities to promote a sustainable metropolitan environment by leveraging the region's assets, and (2) the role and impact of Federal and State incentives programs. Jeremy Nowak is CEO of The Reinvestments Fund – a Community Development Financial Institution that serves the mid-Atlantic region – and is a board member of the Federal Reserve Bank of Philadelphia. Mr. Nowak's discussion will alert public

These issues must be addressed with targeted efforts to ensure a successful recovery effort. An expert on urban affairs, Jeremy Nowak will discuss the state of the regional economy, its housing and job markets, and its infrastructure network. He will discuss (1) opportunities to promote a sustainable metropolitan environment by leveraging the region's assets, and (2) the role and impact of Federal and State incentives programs. Jeremy Nowak is CEO of The Reinvestments Fund – a Community Development Financial Institution that serves the mid-Atlantic region – and is a board member of the Federal Reserve Bank of Philadelphia. Mr. Nowak's discussion will alert public

* These sessions have been submitted to APA for Certification Maintenance approval.



officials and professional planners on what lies ahead, and will lay out a context in which to develop successful policy and planning for the Philadelphia

Jeremy Nowak is the President of The Reinvestment Fund and a nationally recognized leader in urban development. In addition to his work at TRF, Mr. Nowak is a board member of the Philadelphia Federal Reserve Bank. He also chairs the Board of Mastery Charter Schools, a network of four inner city charter middle & high schools in Philadelphia; and Alex's Lemonade Stand, a charity that has raised more \$25 million for pediatric cancer research during the past four years. The author of numerous articles, his recent publications examine policy options for distressed cities; the historical role of religious institutions in community change; the role of development finance for older industrial cities; the challenges of environmental reclamation; and the role of art and culture in neighborhood regeneration. He is currently a Fellow at the Aspen Institute, in a program for entrepreneurial leaders in education, and a member of a Harvard University (Kennedy School) Executive Session on transforming cities through civic entrepreneurship. He holds a PhD from the New School for Social Research and has also been awarded honorary doctorates from Villanova University and La Salle University. In 1995 he received Philadelphia's highest civic honor, The Philadelphia Award.

2:00p – 5:00p ►

OFF PREMISES
MEET IN LOBBY

OFF PREMISES
MEET IN LOBBY

Mobile Workshops

23-M. Open Space and Preservation in the Suburbs — 3 CM*

CHERYL GRAFF TUMOLA, Radnor Township Comprehensive Plan Implementation Committee
DOTTIE IVES DEWEY, PhD, AICP, West Chester University
BEVERLEE S. BARNES, Delaware County Planning Department

24-M. Manayunk, East Falls, and Roxborough Mobile Workshop — 3 CM*

KAY SYKORA, Manayunk Development Corp, The Schuylkill Project
GINA SNYDER, JD, MS, East Falls Development Corporation
BERNARD GUET, Roxborough Development Corporation
ROB FLEMING, Philadelphia University Sustainability Program

2:00p – 2:15p ►

15 Minutes Travel Time



Investing in a sustainable future

DETAILED SCHEDULE

2:15p – 3:30p ▶

CONCURRENT WORKSHOPS—Series D

JEFFERSON A

25. Planning for the Impacts of Development

— 1.25 CM*

DAVID BABBITT, PP, AICP, David C. Babbitt & Associates, LLC

ROBERT C. BENDER, North Wales Water Authority

DANIEL OLPERE, AICP, Local Government Management Services, LLC

SUMMIT 8

26. Grassroots Planning: The Lower Italian Market Revitalization Project — 1.25 CM*

NICOLE HOSTETTLER, PP, AICP, Passyunk Square Civic Association

MINDY WATTS, AICP, Interface Studio

JEFFERSON B

27. Reclaiming Abandoned PA: Tools for Revitalizing Older Communities, Conservatorship for Abandoned Properties — 1.25 CM*

CYNTHIA DALEY, Housing Alliance of PA

IRENE MCLAUGHLIN, JD, Housing Alliance of PA

PAINE

28. Planning by Design: A Model for Main Street — 1.25 CM*

TOM BARTNIK, AICP, LEED AP, Community Design Center of Pittsburgh

BRYAN VAN SWEDEN, Pennsylvania Historical and Museum Commission

CAROL HICKEY, AIA, Hickey Architects



* These sessions have been submitted to APA for Certification Maintenance approval.



SUMMIT 5

29. Pennsylvania Population: 1970-2030 — 1.25 CM*

SUSAN COPELLA, Pennsylvania State Data Center

JONATHAN JOHNSON, The Center for Rural Pennsylvania

SUMMIT 6

30. Philadelphia Regional Greenway Connections — 1.25 CM*

SPENCER FINCH, PE, LEED AP, Pennsylvania Environmental Council

CHRISTOPHER LESWING, AICP, PP, Lower Merion Township

MARC MORFEI, Pennoni Associates

WASHINGTON

31. How to Become an AICP

SUSAN ELKS, AICP, Chester County Planning Commission

MARK STIVERS, AICP, East Hempfield Township

ANDY C. PASZKOWSKI, AICP, PP, Greene Township

3:30p – 4:00p ▶

GRAND

BALLROOM

Refreshments with the Exhibitors and Travel Time

Sponsored by Johnson, Mirmiran & Thompson, Inc.

Visit exhibitors and poster sessions.

Support the scholarship fundraising raffle.



4:00p – 5:30p >

CONCURRENT WORKSHOPS—Series E

JEFFERSON A

32. Legal Aspects of Low Impact and Green Development — 1.5 CM LAW***JONATHAN RINDE, Esq.**, Manko, Gold, Katcher & Fox LLP**BRENDA HUSTIS GOTANDA, Esq.**, LEED AP, Manko, Gold, Katcher & Fox LLP**MEREDITH DUBARRY HUSTON, Esq.**, LEED AP, Manko, Gold, Katcher & Fox LLP

PAINE

33. Sustainably Repositioning Greyfield Sites — 1.5 CM***JIM CONSTANTINE**, Looney Ricks Kiss**MARISA MAZZOTA**, 4ward Planning LLC**TODD POOLE**, 4ward Planning LLC

WASHINGTON

34. From House Museum to Preservation Planning — 1.5 CM***MICHEL R. LEFEVRE, AICP**, PA Historical and Museum Commission

JEFFERSON B

35. Plan Regionally, Implement Locally: Multi-Municipal Planning in PA — 1.5 CM***EDWARD WILSON**, 10,000 Friends of Pennsylvania**JOHN COVER**, Montgomery County Planning Commission**DANNY WHITTLE**, Lancaster County Planning Commission**TOM GRANEY**, Graney Grossman Ray & Assoc

SUMMIT 8

36. Mapping a Sustainable Future: The West Chester Borough Success Story — 1.5 CM***DAVID D. WARD, AICP**, Chester County Planning Commission**DIANNE HERRIN**, BLUER Committee Chair**COURTNEY MARM**, CH2M HILL

SUMMIT 5

37. Successful Open Space Programs — 1.5 CM***MICHAEL STOKES, AICP**, Montgomery County Planning Commission**WILLIAM GLADDEN**, Chester County Open Space Department**KRISTINE KERN**, Bucks County Open Space Department

SUMMIT 6

38. Imagine Philadelphia: Comprehensive Planning for the Mid-Century — 1.5 CM***ALAN UREK**, Philadelphia City Planning Commission**ALAN GREENBERGER**, Philadelphia City Planning Commission**RICHARD REDDING**, Philadelphia City Planning Commission

5:45p – 6:30p >

SE Section Reception (section members only)

6:30p – 8:30p >

**GRAND
BALLROOM****Evening Reception, Dolce Valley Forge***Featuring the Flying Mangos**Sponsored by California University of Pennsylvania
Entertainment Sponsored by Kennedy & Associates*

Enjoy an exotic escape with our tropical-themed evening reception in the Dolce Valley Forge Hotel ballroom. Feast on Caribbean-style food from local sustainable farms and dance to the music of “The Flying Mangos”, a local band featuring the talents of several planners from southeastern Pennsylvania. “The Flying Mangos” are an acoustic-based band whose music takes you on a tour of the rhythmic traditions of Latin America, New Orleans, Hawaii and the Caribbean. You’ll hear well-known tunes by Bob Marley, Harry Belafonte, and the Boss Nova giant Antonio Jobim, along with unique covers of other traditional favorites put to a tropical beat. Feel free to get in the spirit and wear your Hawaiian or tropical garb!

9:00p – 11:00p >

Quizzo Night at Kildare’s Irish Pub

Support the Next Generation of Planners! Following Monday’s evening reception, join all your old and new friends at Kildare’s Irish Pub for drinks and snacks and a rousing match of the popular pub trivia game Quizzo! Kildare’s is located a mile from the Dolce Valley Forge Hotel in a local historical landmark, and features a unique atmosphere with authentic, handcrafted pub fixtures imported from Ireland. Test your brainpower and compete for prizes with a few rounds of Quizzo, or just socialize and enjoy the surroundings. The admission price includes two drink tickets and complimentary snacks. Proceeds go toward the Student Scholarship Fund!

Shuttle buses will provide transportation to and from Kildare’s from the Dolce Valley Forge Hotel. Pick-ups will be at the front of the hotel beginning at 8:45p.m.



Investing in a sustainable future

DETAILED SCHEDULE

TUESDAY
October 6, 2009

9:00a – 10:00a ►
GRAND
BALLROOM

Plenary Session — .75 CM*
SANDY WIGGINS, Principal, Consilience Inc.



Sandy Wiggins is Principal of Consilience, LLC a national consultancy with a mission to build environmentally, socially and economically sustainable communities. His skillful facilitation has helped birth sustainable master plans for municipalities and institutional campuses as well as sustain-

able regional public policy initiatives. During his three-decade career in the real estate industry, he has led the development, design, construction, and restoration of projects totaling over one billion dollars. He is Past Chair of the U.S. Green Building Council, Founding Chair of the Green Building Certification Institute, and served on USGBC's LEED for Neighborhood Development Core Committee and the LEED 2009 Executive Committee. He was also Founding Chair of the Philadelphia based Delaware Valley Green Building Council.

Sandy's vision and leadership have been responsible for the development of dozens of LEED commercial projects and the nation's first LEED Gold certified homes, which were also net zero energy consumers. Current projects include work with several institutional communities that are endeavoring to define and achieve sustainable operations and several real estate projects that include a net zero energy mixed use community and an environmental education campus that aspires to include the nation's first "Living Buildings."

Sandy is also Chairman of the newly formed e3bank, a triple bottom line bank with a mission to facilitate the transition to a green economy. He is a Director of Silpa Inc., an international green building technical services company and a Director of Meidlinger Partners, a venture capital firm focused on emergent green technologies. He serves as a national Director of the Business Alliance for Local Living Economies (BALLE) and on the Advisory Board of Rutgers University Center for Green Building. He is also an adjunct professor in Philadelphia University's Master of Science in Sustainable Design program and lectures on sustainable business practices and green building at the University of Pennsylvania and other educational institutions.

6:30a – 8:00a ►

Fun Run, Valley Forge National Historical Park
Runners, walkers or even bikers can enjoy our early morning fun workout on the scenic five-mile loop trail in Valley Forge National Historical Park. The pathway loop covers mixed terrain and passes numerous landmarks and historic highlights in the park. It is paved making it suitable for all with ample restroom facilities located along the way. Join us as we follow in Washington's footsteps, and enjoy the spectacular scenic natural beauty of this amazing historic landscape before settling down to a full day of conference activities. Transportation from the hotel will be provided at the Dolce Valley Forge Hotel beginning at 6:30am, returning to the hotel by 8:00am.

8:00a – 5:00p ►
GRAND
BALLROOM
LOBBY

Registration Open

8:00a – 4:00p ►
GRAND
BALLROOM

Exhibit Hall Open

8:00a – 9:00a ►
GRAND
BALLROOM

Continental Breakfast in Exhibit Hall.
Sponsored by Wallace Roberts & Todd, LLC
Meet and Greet with Board of Directors
Visit exhibitors and poster sessions.
Support the scholarship fundraising raffle.

* These sessions have been submitted to APA for Certification Maintenance approval.

ECONOMIC DEVELOPMENT

10:00a – 10:30a ►
GRAND
BALLROOM

**Refreshments with the Exhibitors
and Travel Time**
Visit exhibitors and poster sessions.
Support the scholarship fundraising raffle.

10:30a – 11:45a ►
PAINE

CONCURRENT WORKSHOPS—Series F

**39. Planning for Marcellus Shale Developments
& Impacts — 1.25 CM***
NEAL FOGLE, Penn State Cooperative Extension
PETER WULFHORST, Penn State Cooperative
Extension

SUMMIT 5

**40. Water Resources Planning for Sustainable
Pennsylvania Watersheds — 1.25 CM***
ALEXIS MELUSKY, Montgomery County Planning
Commission
KENNETH NAJJAR, Delaware River Basin Commission
PAMELA V'COMBE, MCRP, AICP, Delaware River Basin
Commission

JEFFERSON A

**41. Making TOD Work for Older Neighborhoods
— 1.25 CM***
JENNIFER BARR, Philadelphia City Planning
Commission
PAULA BRUMBELOW, Philadelphia City Planning
Commission
LAURA SEAMAN, Philadelphia Redevelopment
Authority

JEFFERSON B

**42. Using Transportation Dollars to Build
Sustainable and Livable Communities
— 1.25 CM***
DANIELLE SPILA, Pennsylvania Department
of Transportation
BILL PETIT, Pennsylvania Department of
Transportation

SUMMIT 6

**43. Paying for Green Energy and Feasibility for
Co-Generation — 1.25 CM***
JOHN WILLIAMS, USDA Rural Development
ED JOHNSONBAUGH, Penn State Cooperative
Extension

SUMMIT 8

**44. Accommodating Affordable and Senior
Housing in the Comprehensive Planning and
Implementation Process — 1.25 CM***
GLENN NEUHS, Spotts, Stevens and McCoy, Inc.
ROBERT SCHELLHAMER, Spotts, Stevens and
McCoy, Inc.

11:45a – 12:00p ►

15 Minutes Travel Time

12:00p – 2:00p ►
GRAND
BALLROOM

Annual Meeting, Awards Program and Luncheon

*Sponsored by Delaware Valley Regional
Planning Commission*

It is once again time to celebrate the achievements of Pennsylvanians who shape where we live, work, and play! Join Brian O'Leary, AICP, chair of the PA Chapter Awards Committee, for an inspiring awards program. We will recognize the work of planners, planning officials, and elected officials - and their roles in planning Pennsylvania.

Following lunch PA Chapter President Alex Graziani, AICP will present the "State of the Chapter," highlighting our successes in the past year, and outlining our priorities for your support to contribute to the health of the planning profession and the PA Chapter of APA in the coming year.

2:00p – 2:15p ►

15 Minutes Travel Time

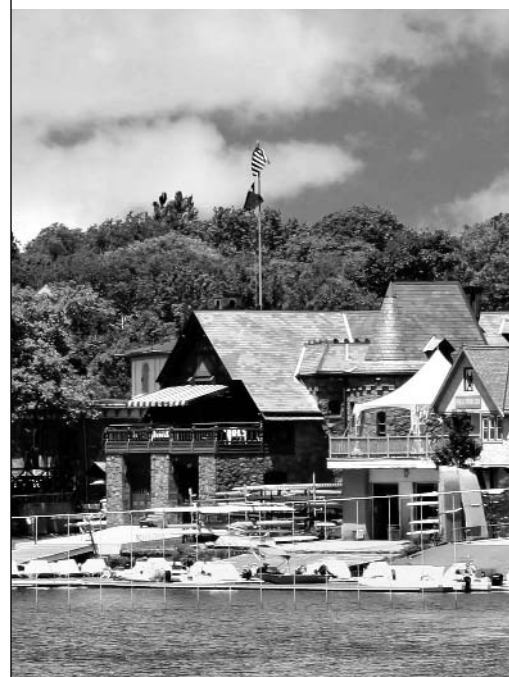



Investing in a sustainable future

DETAILED SCHEDULE

2:15p – 3:30p ➤

CONCURRENT WORKSHOPS—Series G

PAINE

45. Creating Successful Planning Commissions
— 1.25 CM*
ELIZABETH ROGAN, AICP, Lower Merion Township
Commissioner
ANN HUTCHINSON, Natural Lands Trust
FRED FROMHOLD, Esq., Fromhold, Jaffe & Adams

SUMMIT 5

**46. Greater Philadelphia's Food System:
The Complexities of Planning for a Local Food
System** — 1.25 CM*
ALISON HASTINGS, Delaware Valley Regional
Planning Commission
AMANDA WAGNER, Delaware Valley Regional
Planning Commission
ANN KARLEN, Fair Food and The Common Market
ELLEN HOLTZMAN, The Food Trust

JEFFERSON A

47. Design Standards in Urban Zoning
— 1.25 CM*
BRIAN O'LEARY, AICP, Montgomery County
Planning Commission
HOLLY MAGER, Montgomery County Planning
Commission
SCOTT FRANCE, Montgomery County Planning
Commission

SUMMIT 6

**48. Local Government Responses to Community
Planning for Aging: Three Approaches to
Addressing Aging in Place** — 1.25 CM*
LYNN REYNOLDS, MS, Carter van Dyke Associates
BRIAN DUKE, Bucks County Area Agency on Aging
ANNE LEAVITT-GRUBERGER, AICP, Montgomery
County Planning Commission



SUMMIT 8

**49. Connecting Planners with the TreeVitalize
Program to Enhance Tree Canopy in PA Commu-
nities** — 1.25 CM*
PATTY ELKIS, Delaware Valley Regional Planning Com-
mission
MICHAEL LEFF, TreeVitalize Program at
Pennsylvania Horticultural Society
DR. BILL ELMENDORF, Penn State School of Forest
Resources
JOE FRASSETTA, PA Department of Conservation and
Natural Resources
ELLEN ROANE, PA DCNR
LISA CEOFFE, Urban Forester

JEFFERSON B

**50. Linking Redevelopment Areas with Transit in
Philadelphia** — 1.25 CM*
CHRISTOPHER JANDOLI, AICP, Parsons Brinckerhoff
ROBERT BOX, Port Authority Transit Corporation

3:30p – 4:00p ➤

**GRAND
BALLROOM**

**Refreshments with the Exhibitors
and Travel Time**
Sponsored by Herbert, Rowland & Grubic, Inc.
Visit exhibitors and poster sessions.
Support the scholarship fundraising raffle.

4:00p – 4:30p ➤

Exhibits Tear Down

* These sessions have been submitted to APA for Certification Maintenance approval.

4:00p – 5:30p ▶

CONCURRENT WORKSHOPS — Series H*JEFFERSON A*

51. Annual Land Use Law Update — 1.5 CM LAW*
SUSAN SMITH, Esq., Smith Cartwright LLP

SUMMIT 5

52. The AICP Code of Ethics and Real World Scenarios — 1.5 CM ETHICS*
DEBORAH HOWE, PhD, FAICP, Temple University
SUSAN ELKS, AICP, Chester County Planning Commission

JEFFERSON B

53. Outlawing Sprawl — 1.5 CM*
WALTER WYDRO, Newtown Area Joint Planning Commission
RONALD BAILEY, Chester County Planning Commission

SUMMIT 8

54. Spatial Design and Planning for Neighborhood-Centered Elder Housing and Care — 1.5 CM*
GREGORY OLSEN, Penn State University and Patina Consultants

PAINE

55. Progressive Planning for the US 422 Corridor — 1.5 CM*
SHAYNE TRIMBELL, GVF Transportation
JERRY COYNE, Delaware Valley Regional Planning Commission
LEO BAGLEY, Montgomery County Planning Commission

SUMMIT 6

56. Zoning the Appalachian Trail: Implementing State Legislation to Protect a National Resource — 1.5 CM*
ROB KERNS, Wallace Roberts and Todd
ED LECLEAR, PA Department of Community & Economic Development



SEE YOU NEXT YEAR!

October 3–5, 2010
 Lancaster Convention Center
 and
 Marriott Lancaster at
 Penn Square



Investing in a sustainable future

POSTER SESSIONS

POSTER SESSIONS

Poster sessions will be displayed near the Grand Ballroom Lobby.
The following sessions will be on display:

1

Managing Stormwater and Improving Neighborhoods: Green Infrastructure in Philadelphia

GLEN ABRAMS, AICP, Philadelphia Water Department Office of Watersheds

MAMI HARA, ASLA, AICP, Wallace Roberts & Todd, LLC

2

Philadelphia Metro Area Hunger Relief and Community Food Access Study

MAHBUBUR R. MEENAR, M.U.P., Center for Sustainable Communities, Temple University

KYLE GUIE, Temple University, Community & Regional Planning Program

3

Sustainable Zoning - to Promote Compact Development, Reduced Energy Use and Land Conservation

CHARLIE SCHMEHL, Urban Research and Development Corp.

4

Sustaining Downtowns: How Community Benefit Districts (CBDs) Can Help

DONNA TAGGART, Taggart Associates, Inc.

ALLYSON FILIPPS, Esq., Taggart Associates, Inc.

5

Targeted Public Outreach to Support Water Infrastructure and Green Solutions

ANGELA DIXON, Hurley~Franks & Assoc

ERIC LEINHARD, Greeley and Hansen

6

Pennsylvania Land Choices: An Educational Guide Connecting Communities and Local Government Through Education

ESTELLE RUPPERT, PA Department of Conservation and Natural Resources

7

Measuring the Unmeasured: Solid Waste Data Availability at the Municipal Level in Pennsylvania

CHLOE M. MAHER, Temple University, Center for Sustainable Communities

BRADLEY FLAMM, Temple University



Student-centered learning.
Respect for the environment.
Community engagement.



Community and Regional Planning

Temple University Ambler and Harrisburg Campuses

- Program focus on sustainability, environmental and regional planning, and advanced computer applications
- Terrific faculty with extensive professional planning experience
- Strong student cohorts and small class sizes
- Convenient evening classes to meet needs of working professionals
- Applied research and community service opportunities through the Center for Sustainable Communities
- Research assistantships to finance graduate studies

EXPLORE THE POSSIBILITIES. TRY A COURSE. START YOUR FUTURE TODAY.



Department of Community & Regional Planning
School of Environmental Design
580 Meetinghouse Road, Ambler, PA 19002
267-468-8300
crp@temple.edu
www.temple.edu/ambler
www.temple.edu/harrisburg