



I-95 GIRARD AVE INTERCHANGE

Douglas Robbins, AICP, PP





History, Limits, Expectations

State DOTs don't do urban.

- Rina Cutler, Deputy Mayor for Transportation and Utilities, City of Philadelphia

DOTs have two stages – 'Too soon to tell' and 'It's too late to change'

- Peter Park, Planner at Reimagining Urban Highways Presentation

Sweet Jesus!

- John Connor, Penn Treaty Museum Curator, (At a Presentation for the Girard Avenue Interchange – He was happy.)

I-95 Girard Avenue Interchange

- Just North of Center City Philadelphia

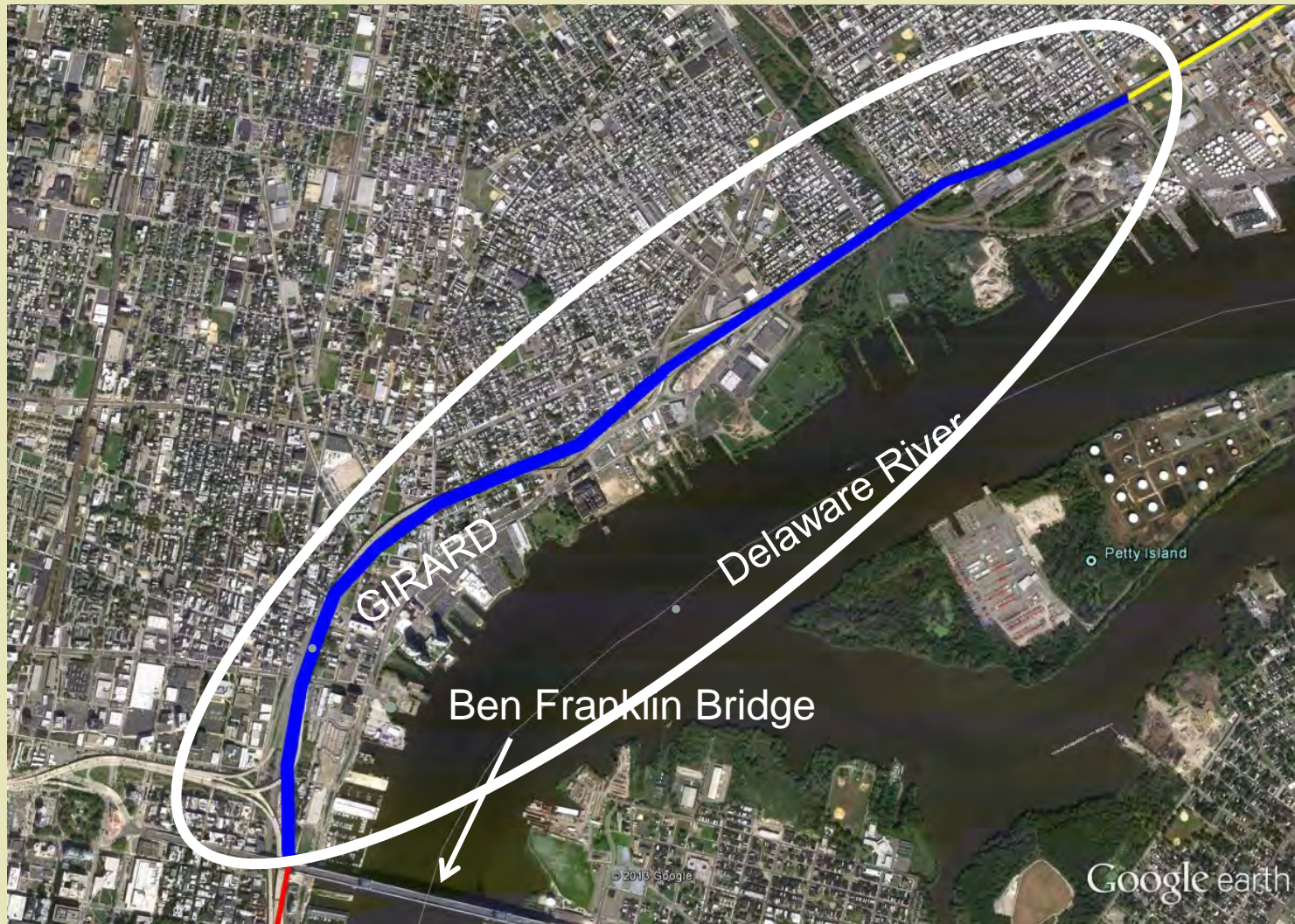

Urgency, Location, Consensus

- A Lot of Money Spent All in One Place
- Limited Regional and Commonwealth Resources
- Girard Avenue Interchange is over \$1 billion by itself

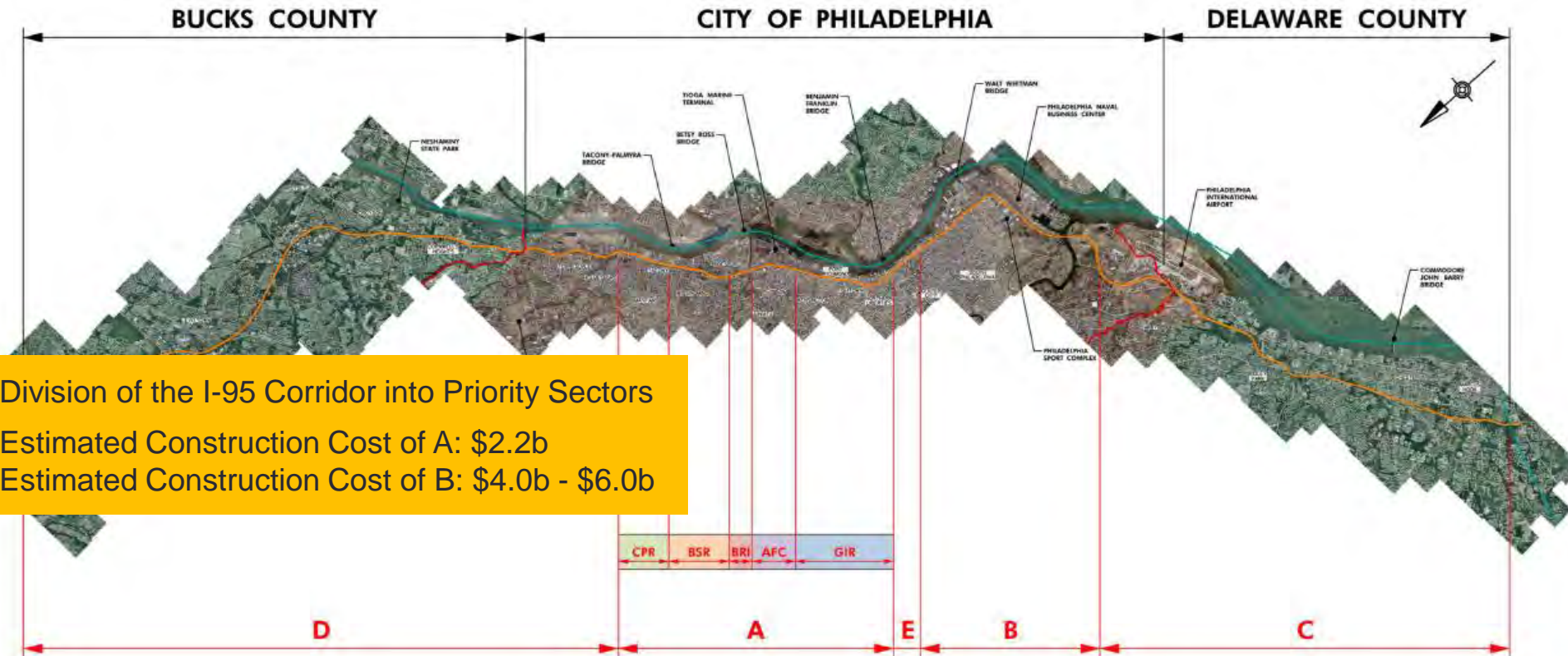

Working in an Urban Highway Environment

- Everything has been piled together over the last 100 or more years

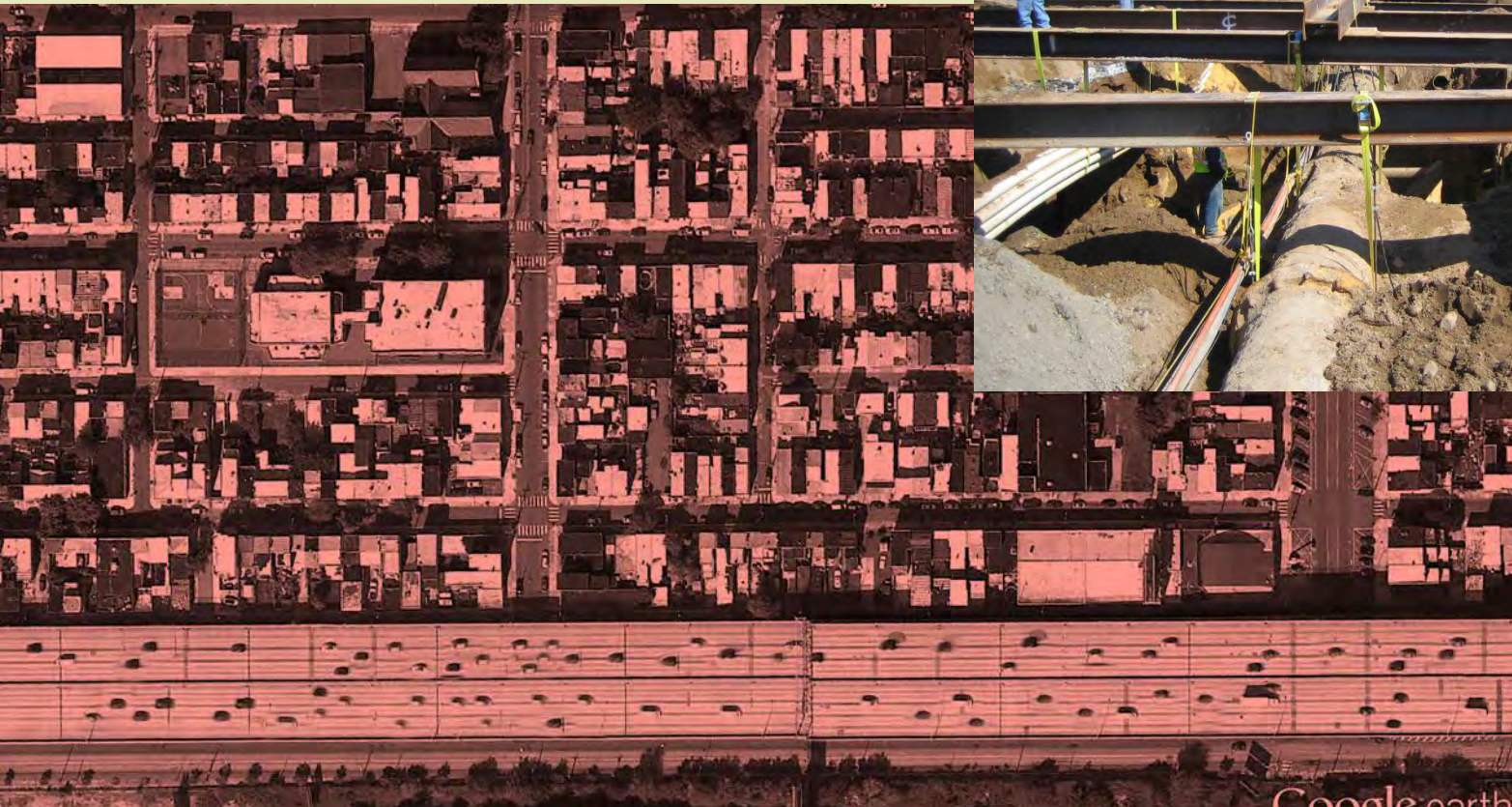

PennDOT Approach

- Become an Active Participant
- Respond Proactively
- Create a Human-Scaled Environment
- Build Partnerships

You are invited to attend an

I-95 Girard Ave. Project Meeting

To learn about ongoing and upcoming construction for the I-95 Girard Interchange.

- Detours
- Parking and access under the highway
- Construction schedule





To give feedback on neighborhood needs, such as:

- Parking
- Public Access
- Landscaping
- Lighting





When	Tuesday October 1, 2013 6:30pm	AND*	Thursday October 3, 2013 6:30pm
Where	Mother of Divine Grace Parish 2612 East Monmouth Street Philadelphia, PA		Penn Treaty Museum at the corner of Columbia and Delaware Avenues Philadelphia, PA

*The same information will be presented at both meetings.



For more information please contact:
Marian Hull at marian.hull@urs.com or 215.940.9270
And remember to visit us at www.95revive.com



INTEGRATING I-95 INTO THE WATERFRONT

Introducing Flexibility to a Decades Long Design Process

Residents and the River

- Historically close, but not connected



© City of Philadelphia, Department of Records

Pier No. 67 North; July 23, 1919; Negative No. 493
South Side, looking East, Showing Trees, etc.

Central Delaware Vision & Master Plan

- Initial Culture Shock Turned to Call for Action
- Learning to Work Together to Increase “Permeability” of Highway

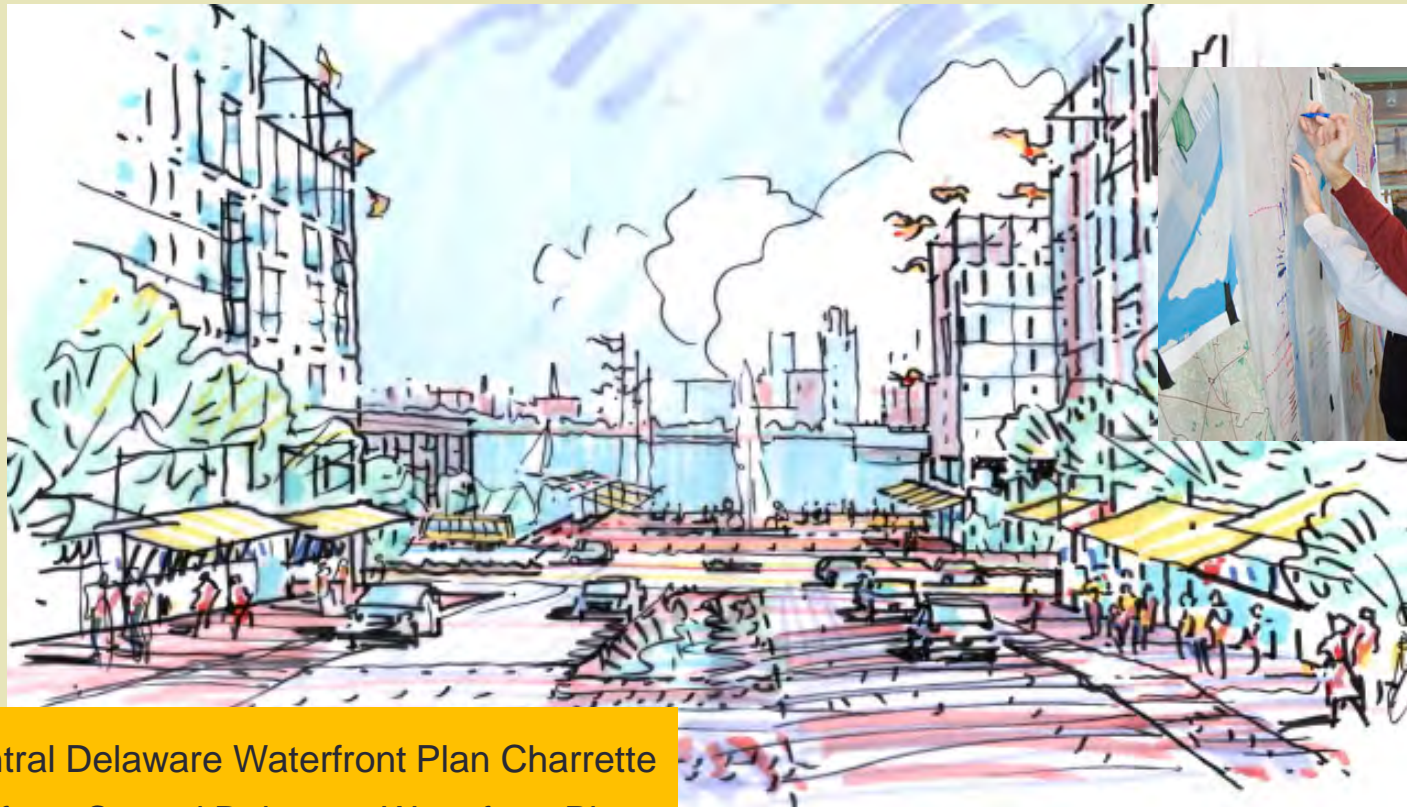

Photo: Central Delaware Waterfront Plan Charrette
Rendering from Central Delaware Waterfront Plan:
Market Street at Penn's Landing

Waterfront Connections

- 20-acres of Land under Structures
- Many Access Locations – But They Are Not Places Anyone Wants to Be



Waterfront Connections

- But They Could Be...

“It'll be awesome to look out there and see plants instead of prostitutes.”

-Area resident

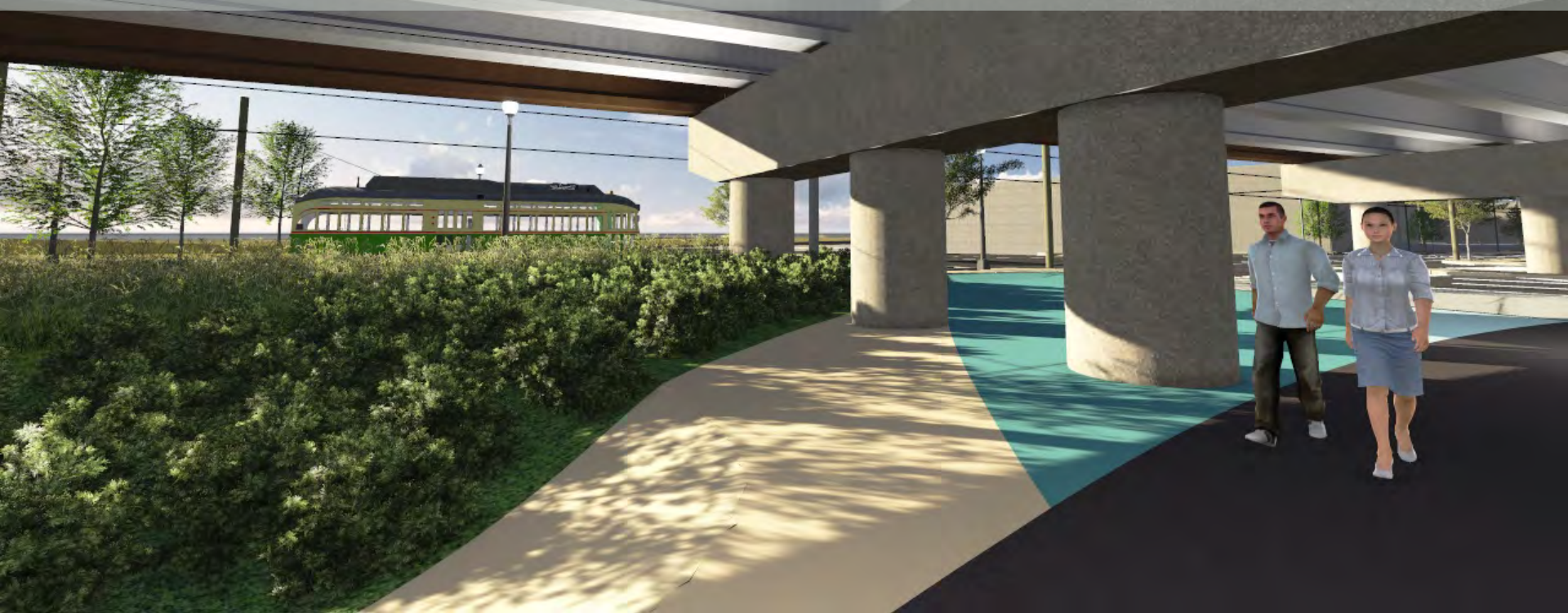



SUSTAINABLE ACTION COMMITTEE

A Communication & Implementation Structure

Intersecting and Competing Interests

- Pennsylvania Department of Transportation
- City of Philadelphia
- Federal Highway Administration
- Neighborhood Community Development Corporations
- Neighborhood Associations
- SEPTA, AMTRAK, Conrail
- Verizon, PECO, PGW, PWD
- Real Estate Developers, Commercial, and Industrial Landlords
- Retail Businesses
- Residents
- Travelers
- Elected Officials

Sustainable Action Committee (SAC)

- Corridor Sustainable Action Committee
 - FHWA, PennDOT, City and Regional agencies, Major non-profits
 - Consistency in Corridor-wide Policy Decisions
- Girard Avenue Sustainable Action Committee
 - Civic Organizations, Non-profits, PennDOT, Relevant City Agencies
- Results
 - Integrated Stakeholder and Community Needs into the Design and Environmental Clearance Process

Sustainable Initiatives



Safer Pedestrian Environment

Stormwater Management



Improved Waterfront Access

Recreation and Green Space



Public Art and Storytelling



Sustainable Action Committee

- PennDOT Working Collaboratively with Agencies & Non-Profits to Identify Role of I-95 Reconstruction in Implementing Waterfront Projects
 - Can Implement Some
 - Lay Groundwork for Many
 - Not a Factor in Others

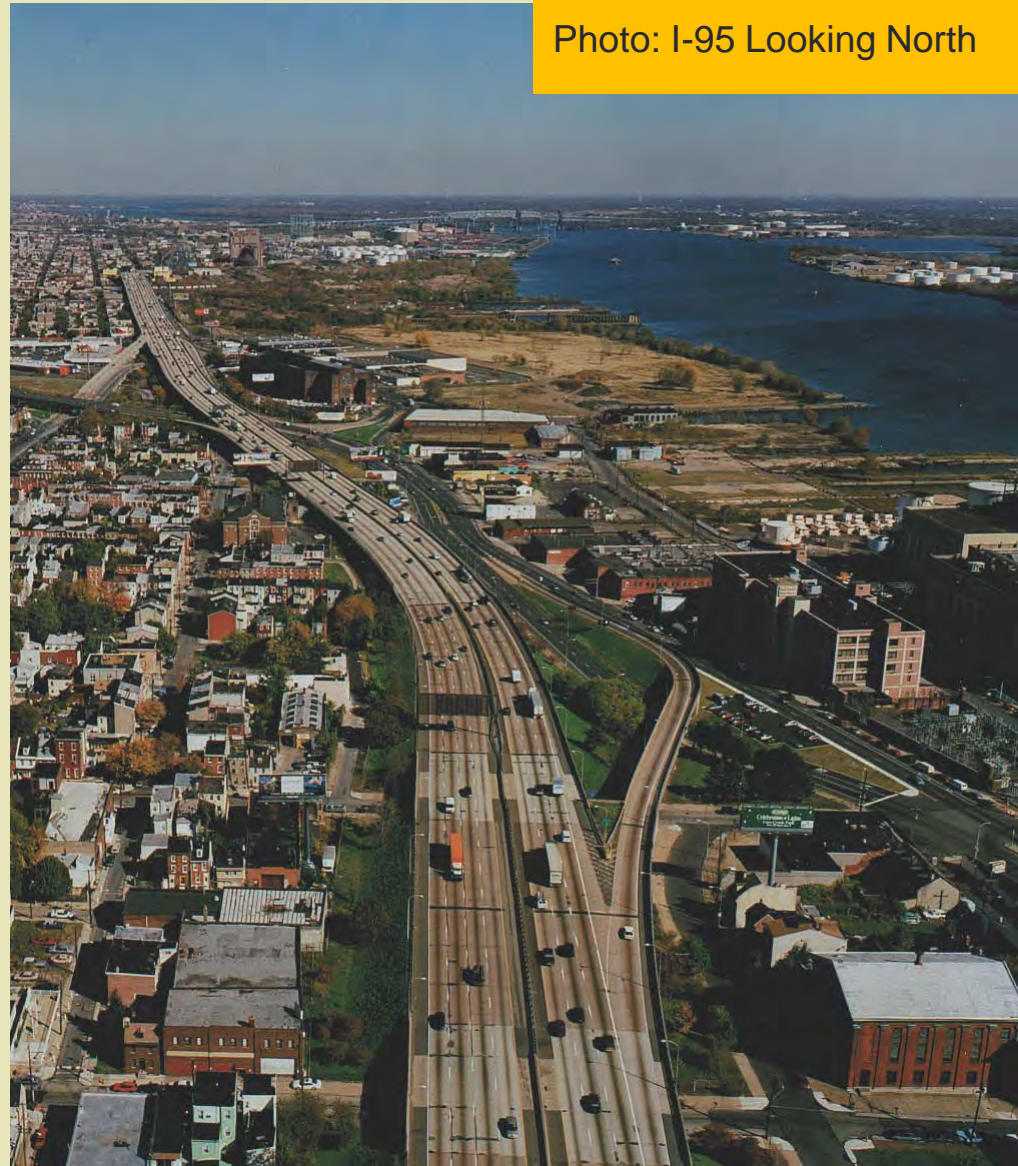

Photo: I-95 Looking North



THE NEED TO SPEAK A COMMON LANGUAGE

Not Everyone is an Engineer



Visualizing a Highway



Committee Meetings

I-95 Girard Avenue Interchange

Open Space Network

Legend

CO41	IND4
CO42	REC
CO45	RES2
IND3	RES3

Total ROW in Acres

Block	Total ROW in Acres
1	1.28
2	0.55
3	1.71

* Most of land oc

① Shackamaxon St. to Palmer St.

Possible Uses:

- Linear park
- Gardening space
- Dog park
- Extension of Penn Treaty Park

I-95 Girard Avenue Interchange

Open Space Network

Legend

CO41	IND4
CO42	REC
CO45	RES2
IND3	RES3

Total ROW in Acres

Block	Total ROW in Acres
1	1.28
2	0.55
3	1.71

* Most of land occupies existing PennDOT ROW and is not zoned for any use

② Palmer St. to Aramingo Ave.

Possible Uses:

- Landscaped community parking lots
- Some parking used as flex space on weekends for markets
- Overflow parking for events at Penn Treaty Park
- Pocket dog parks

Legend

CO41	IND4
CO42	REC
CO45	RES2
IND3	RES3

Total ROW in Acres

Block	Total ROW in Acres
4	1.12
5	1.29
6	3.56

Acres Under Structure

Block 4	1.12
Block 5	1.29
Block 6	2.82
Total	0.73

Acres Adjacent to Structure

Block 4	0.00
Block 5	0.00
Block 6	0.00
Total	0.00

Land Receiving Sunlight

In Acres	% of total	4-6 Hours		6-8 Hours		Over 8 Hours		Existing Zoning*
		In Acres	% of total	In Acres	% of total	In Acres	% of total	
0.94	94%	0.18	18%	0.00	0%	0.00	0%	N/A
0.97	78%	0.20	18%	0.10	8%	0.00	0%	N/A
1.51	42%	0.83	23%	0.74	21%	0.48	14%	N/A



Neighborhood/Near Neighbor Meetings

URS

1-95 Girard Avenue Interchange
Marlborough Street

Landscaping and Underpass Lighting

Below are example views from around Marlborough Street that show the landscaping and underpass lighting improvements as well as noise barrier with clear tops on the tallest wall sections.



Landscaping - Green & Open

1. Integrate plantings with stormwater requirements
2. Linear rain gardens will define the space
3. Tiered landscaping to screen retaining walls from view
4. Use of "security plants" & minimal fencing to keep people out

Lighting - Bright & Secure

5. City-approved LED fixtures
6. Roadway & "wall wash lights" to provide high-quality lighting



URS

1-95 Girard Avenue Interchange
Near Neighbors Meeting

Noise Barriers with or without Clear Tops

Below are example views that compare noise barriers with clear top panels to views of all solid walls. Please review them and tell us which design you like best at each location.

Solid with Clear Tops	All Solid
<p>1 The corner of Shookamexon and Richmond Streets looking north along the east side of I-95</p>  <p>Best design for this location</p>	<p>1 The corner of Shookamexon and Richmond Streets looking north along the east side of I-95</p>  <p>Best design for this location</p>
<p>2 View on the highway traveling northbound between Shookamexon and Marlborough Streets</p>  <p>Best design for this location</p>	<p>2 View on the highway traveling northbound between Shookamexon and Marlborough Streets</p>  <p>Best design for this location</p>
<p>3 The corner of Columbia Avenue and Soliman Street looking south along the west side of I-95</p>  <p>Best design for this location</p>	<p>3 The corner of Columbia Avenue and Soliman Street looking south along the west side of I-95</p>  <p>Best design for this location</p>



Community Events



DIGGING THE CITY
September 21, 2012 - February 3, 2013
www.phillyseaport.org

It Ain't Your Grand Pop's Riverfront Anymore!
Wednesday, May 25th
6:30-8:30 PM
Campbell Square Park (Allegheny & Belgrade)

Get the latest scoop on 'River Rumors'. Guests include representatives from PennDOT, Delaware River City Corp, Delaware River Waterfront Corporation and others!

Hear about I-95 and new public access near the highway!
Learn about the Port Richmond Trail!
See the Delaware River Waterfront Corporation's Riverfront Master Plan!
Brainstorm on getting better connected to the riverfront!

To volunteer, have a table, or learn more:
Call Patty-Pat 215-816-3363, Laura Lanza 215-990-3196 or Tom Potts 215-427-0350 x119

Rain location: across the street at Our Lady Help of Christian, Downstairs Hall

DISCOVERIES AT A WATERFRONT

URS **pennsylvania** **Federal Highway Administration**

Sponsored by PROPAC (Port Richmond on Patrol and Civic) and NKCDC.
Thanks to the Friends of Campbell Square for helping host this event!



UNCOMMON PURPOSE

An I-95 for Everybody



Movement at Multiple Levels

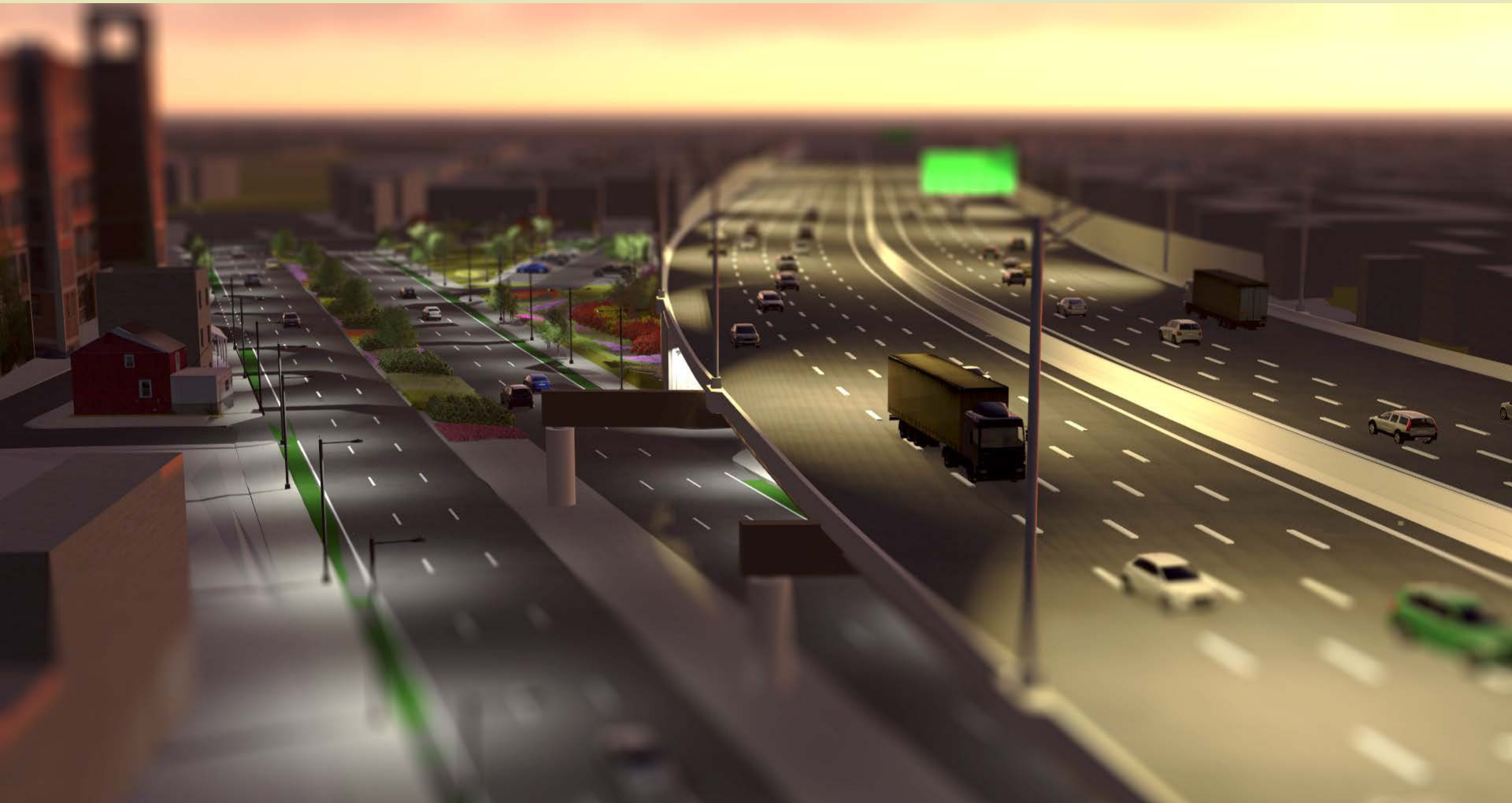

Elevated Highway and Surface Streets Overlapping

Perpendicular and Parallel

- Making it Easier and Safer to Travel Across and Along the Highway for Everyone

Crossing Under the Highway

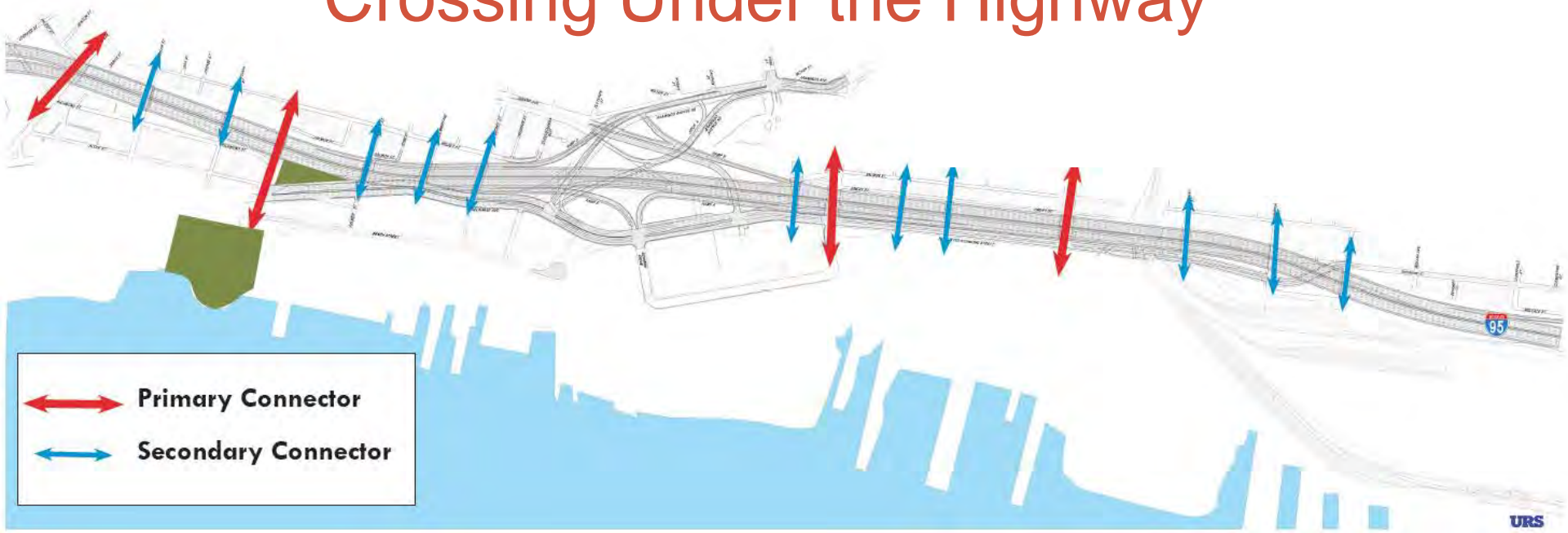

Perpendicular and Parallel

- Making it Easier and Safer to Travel Across and Along the Highway for Everyone

Moving Parallel to the Highway





Underpasses (Perpendicular)

- Charged with pushing the boundaries of standard highway lighting considerations





Under Viaduct (Perpendicular)

- Terminating Vistas
- LED Lighting
- Open, Usable Spaces



Trails (Parallel)

- Used to separate stormwater BMPs and parking lots
- Ground mounted lighting



Surface Streets (Parallel)

- Integration with Transit Service
- New Trail, Bike and Sidewalk Connections



Interchange

A multi-use trail will pass through the area to connect to Girard Avenue through the stormwater park.



Interchange



Wall under new off-ramp – Historical Map Design

COMMUNITY PARTNERSHIPS

Building on Each Other's Strengths

DRWC – Implementing the Master Plan

- Work Like a Relay Team
- PennDOT Does What it Does Well
 - Build the Infrastructure
- DRWC Does What it Does Well
 - Manage and Execute Projects to Enliven Public Spaces



“Baseline” Underpass Treatments

- Important Connections to Waterfront
- Wall Treatments that Reflect Culture of Local Neighborhood





Columbia Avenue Primary Connector



Columbia Avenue Primary Connector

- Park at Columbia will include a large lawn/gathering space, rain gardens, and parking.



Spring Garden Primary Connector

- Highway Reconstruction not Scheduled until 2018-2020
- DRWC Leading Initial/Interim Improvements for this Critical Link
 - Underpass Lighting & Design
 - Transit Access/Wayfinding Improvements
 - Streetscaping & Public Art
- Future Highway Construction Will Conserve Interim Improvements



From Vision... to Design... to Construction



Photo: Ramp Entrance and Mainline Viaduct
Girard Avenue Interchange

Rendering from Central Delaware Waterfront
Plan: Viaduct Structure and Landscaping
Girard Avenue Interchange

Rendering of URS Proposed Viaduct and
Landscaping

THANK YOU

<http://www.95revive.com/>