

Centre Region Bicycle and Pedestrian Initiatives

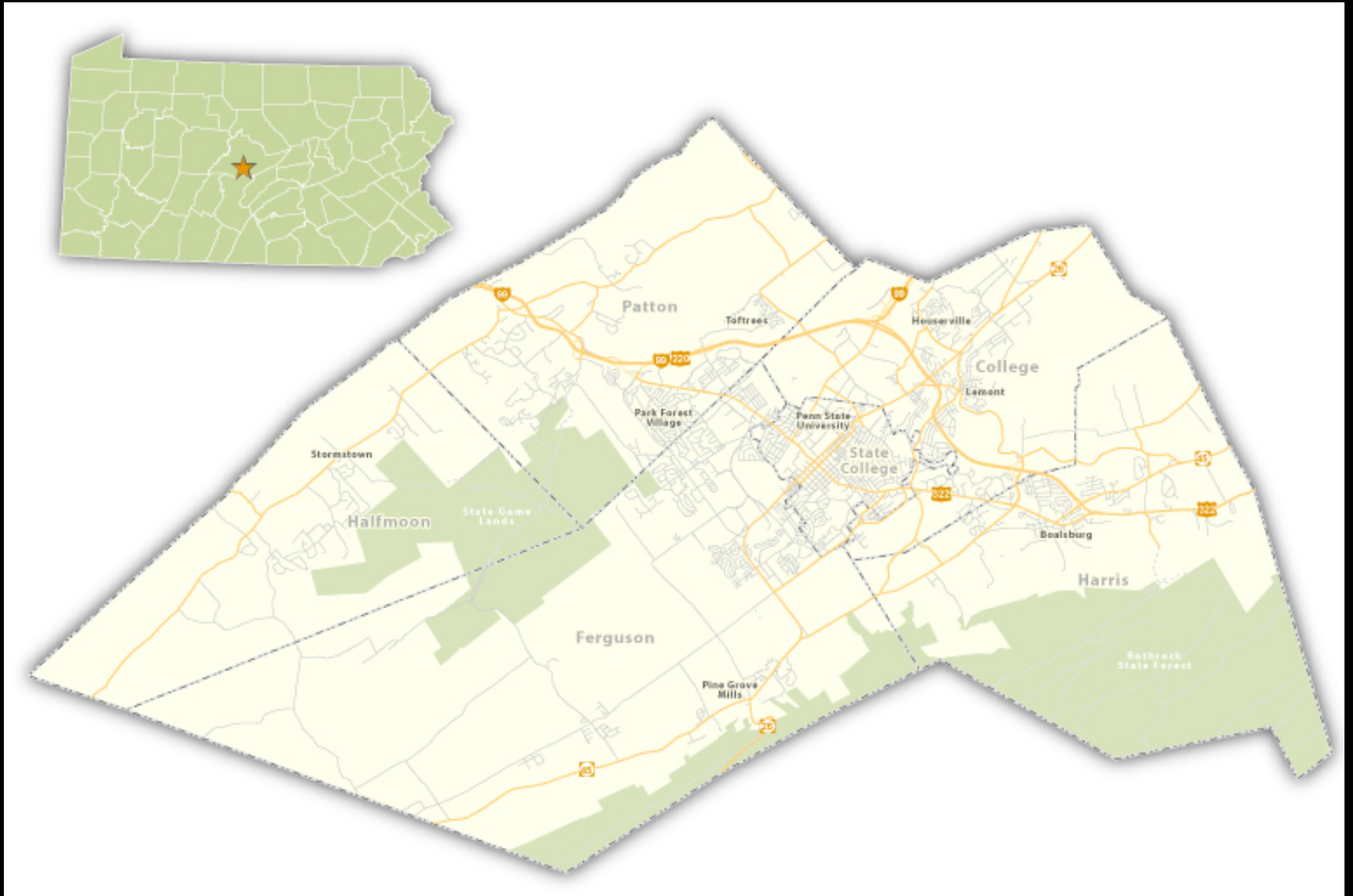

*Planning on the Move: Hot Topics in Transportation – Harrisburg, PA
November 3, 2016*

THE CENTRE REGION



EXISTING BICYCLE FACILITIES



2012 – BRONZE LEVEL BICYCLE FRIENDLY COMMUNITY



FEEDBACK REPORT

“Develop a
comprehensive
bike plan”

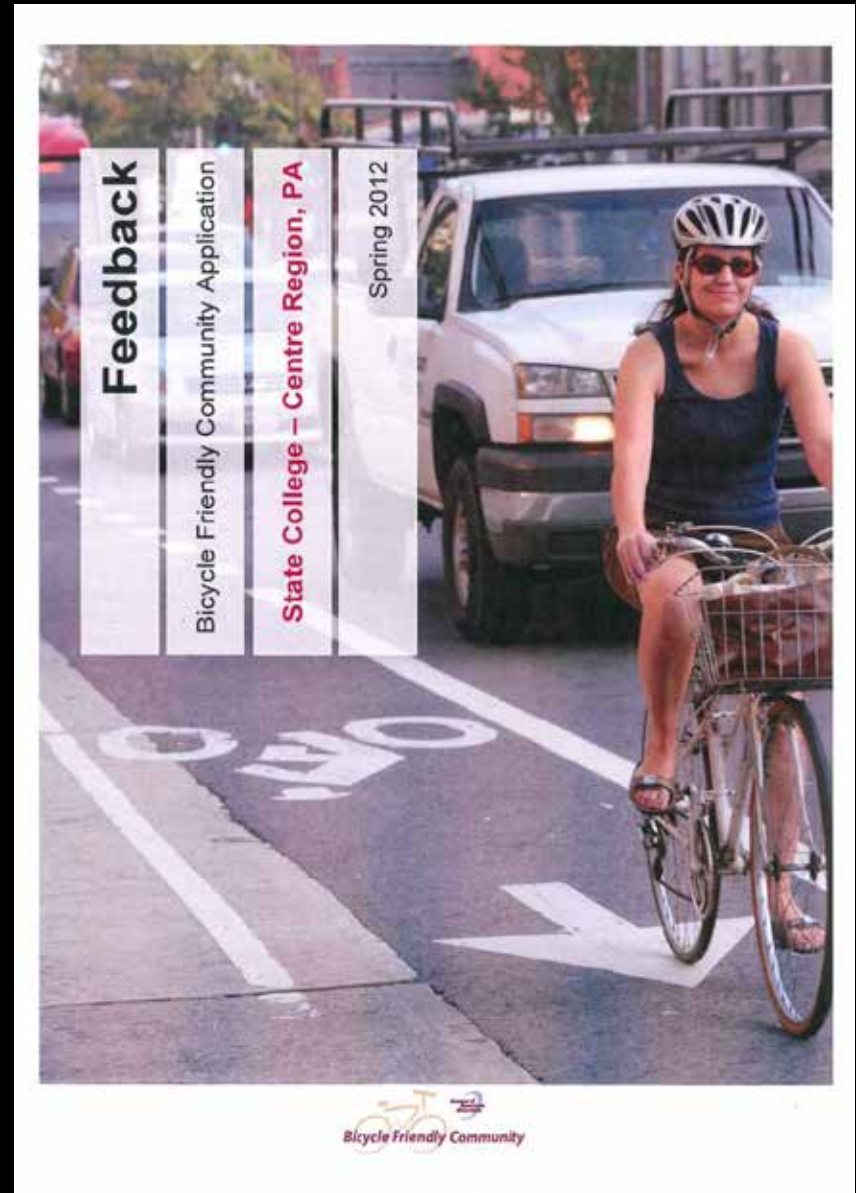



CENTRE REGION BIKE PLAN

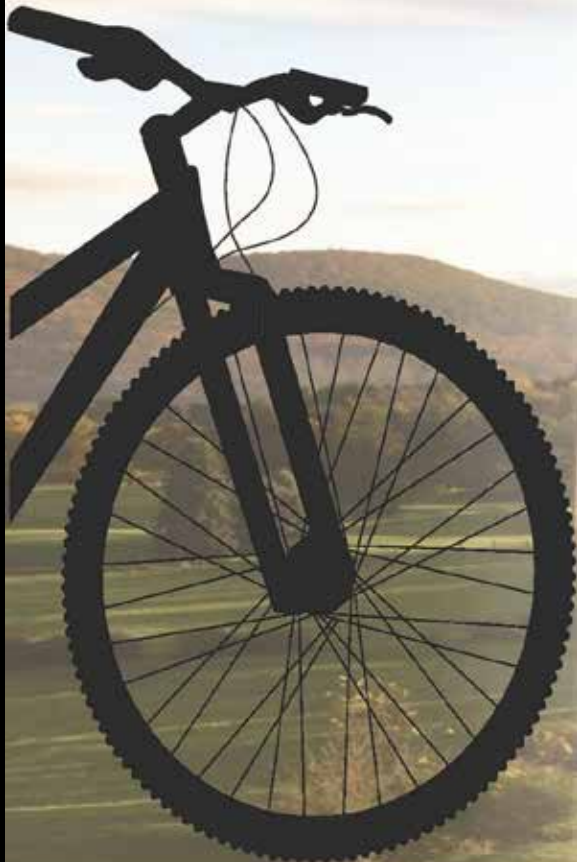

*A Bicycle Friendly
Community*

Adopted December 15, 2015
Amended May 23, 2016

PUBLIC INPUT TOOL

A flyer for the Centre Region Bike Plan. It features a silhouette of a bicycle on the left side against a background of a hazy landscape with hills. At the top left is the logo for the Centre Region Council of Governments (CROG), which includes a stylized 'C' and 'R' inside a circle with the words 'REGIONAL PLANNING' around it. The main title 'CENTRE REGION BIKE PLAN' is in large, bold, black letters, with the subtitle 'A Bicycle Friendly Community' below it. A list of four questions is centered on the page, asking about priorities, destinations, and amenities for bicycling. At the bottom right, there is a green box with white text that says 'Residents are encouraged to provide input at www.crcog.net/bikes or scan' followed by a QR code. At the very bottom, there is a green bar with white text that says 'Contact Trish Meek for more information at tmeek@crcog.net or 814-231-3050'.

- Listservs
- Municipal Websites
- Newsletters
- E-Newsletters
- C-Net
- Community Events
- Media Interviews
- OnTarget Flyer
- Active Guide

FACILITY TYPE PREFERENCE - OVERALL

Please select your preference for the following bicycle facilities, whether or not you bike:

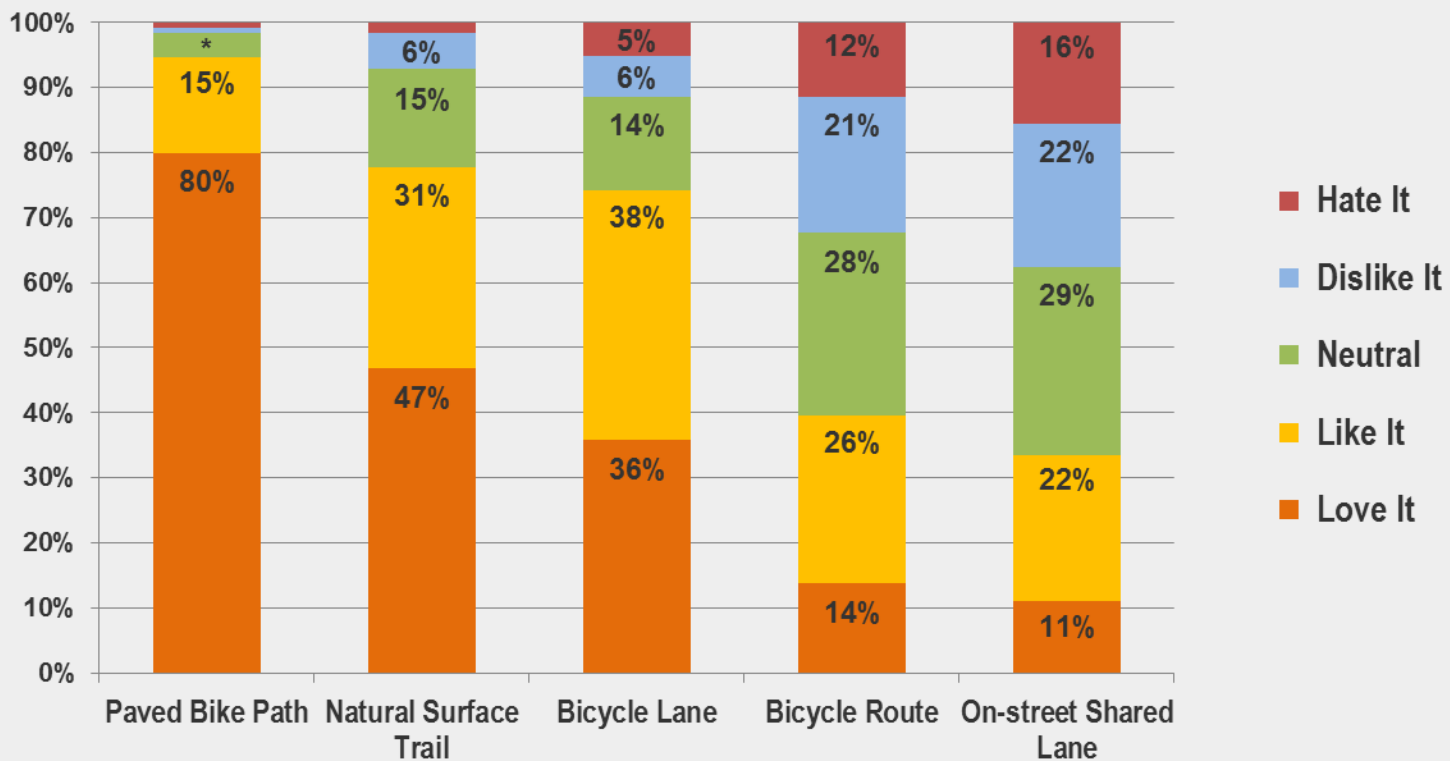

* Values of less than 5% are not labeled.

FACILITY TYPE PREFERENCE – TYPE OF RIDER

Preference for Paved Bike Paths by Type of Rider

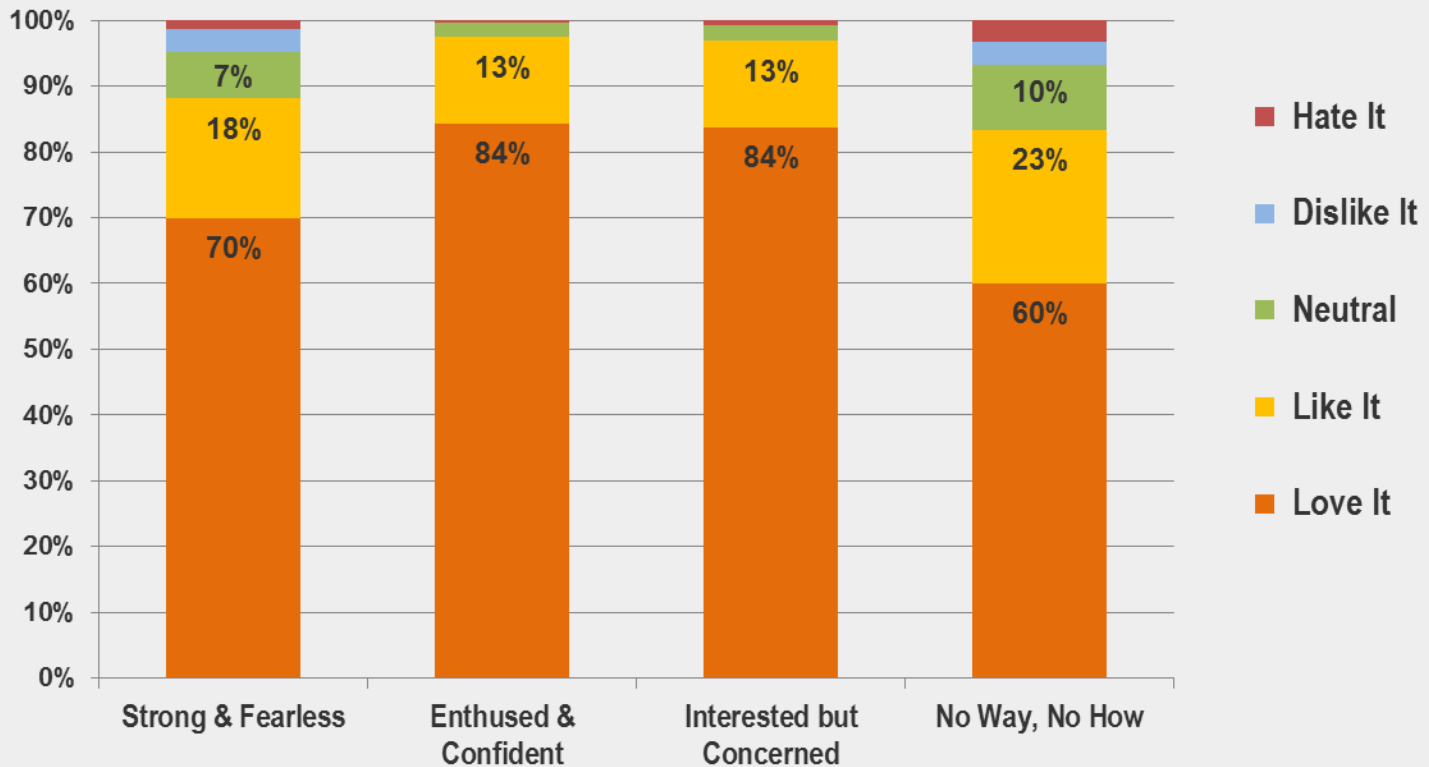

* Values of less than 5% are not labeled.

FACILITY REQUESTS

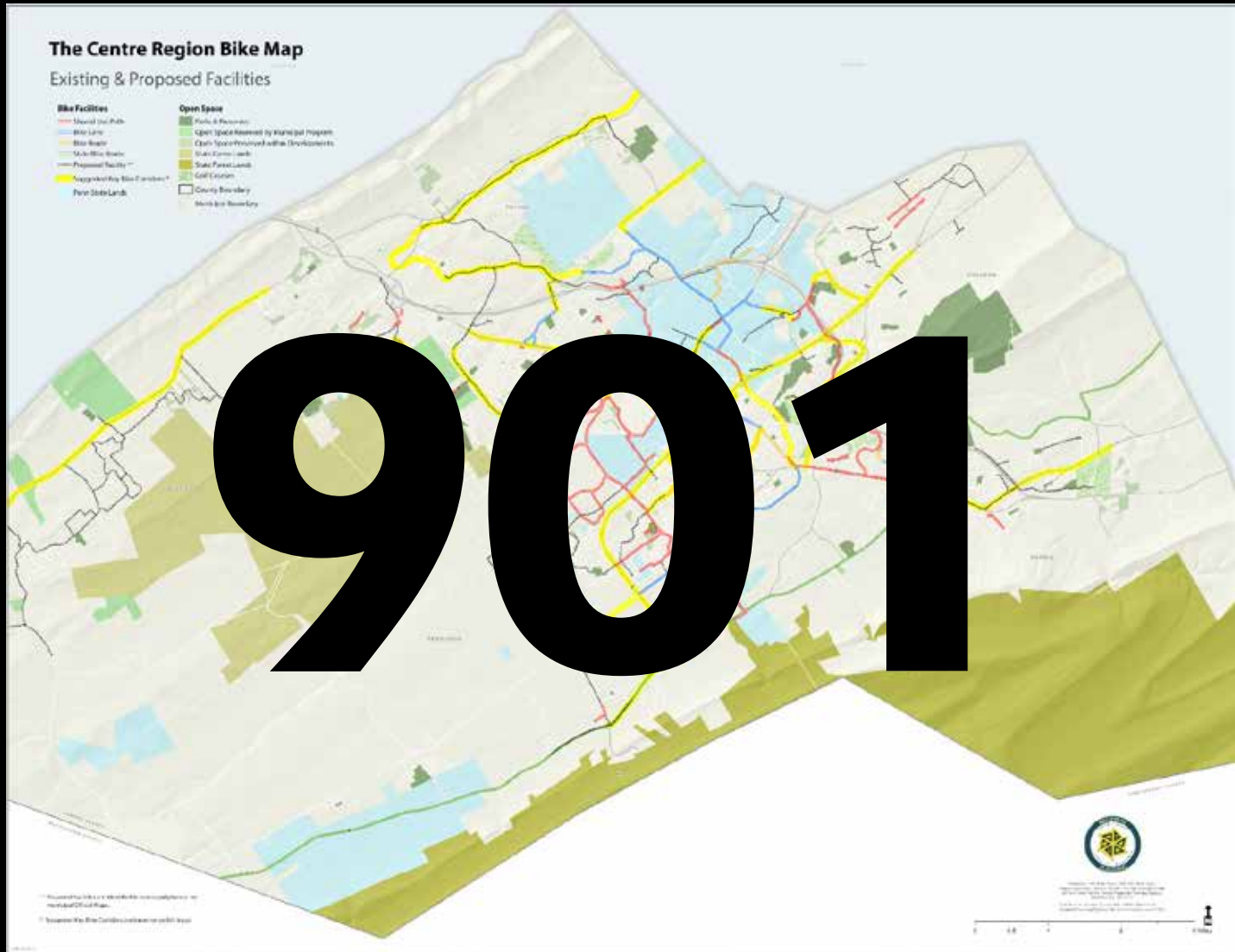

RECOMMENDED CORRIDORS

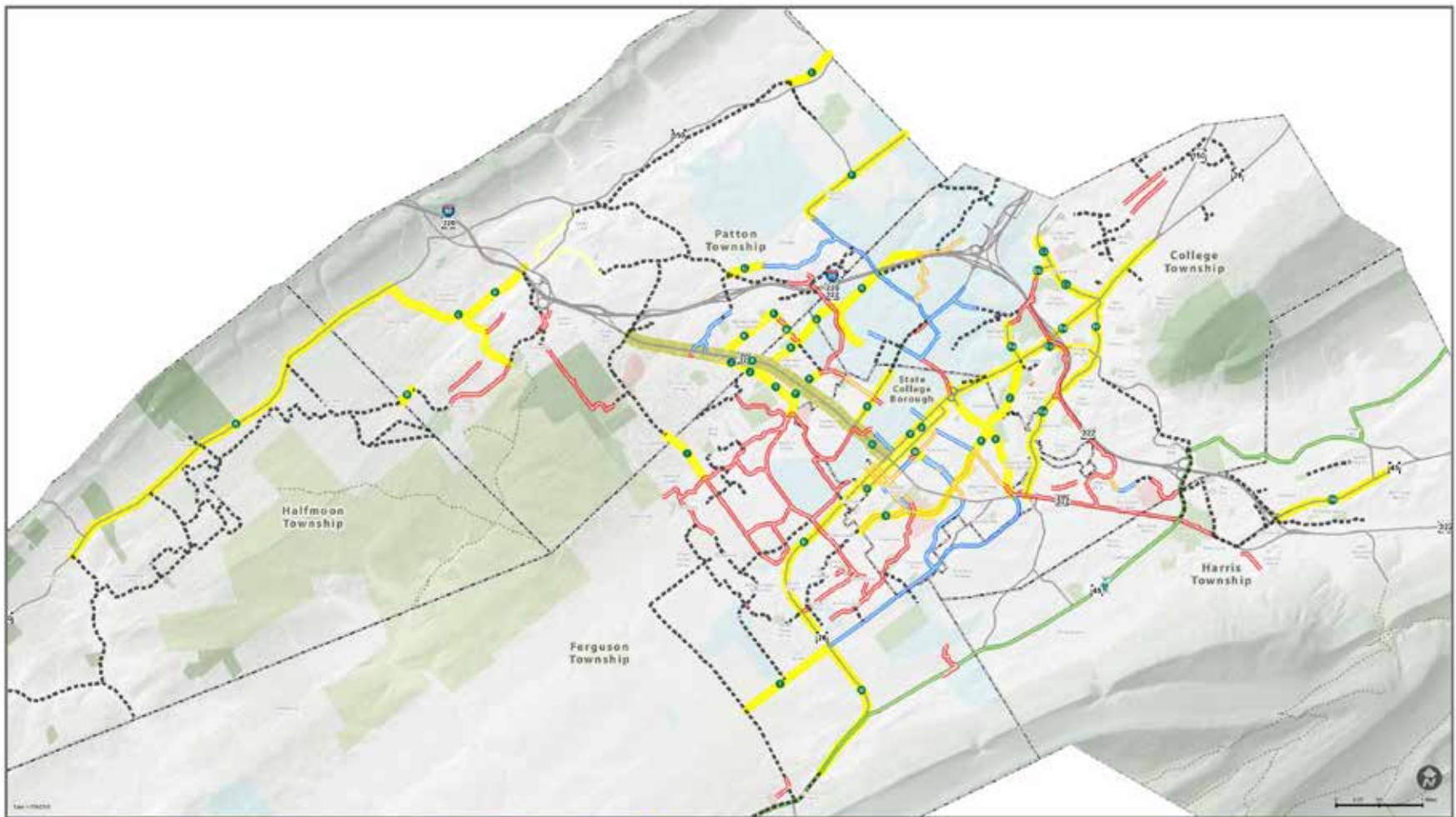

Centre Regional Planning Agency
 2000 University Drive
 State College, PA 16801
 814.237.2300
 www.crapa.net

- Shared Use Path
- Bike Lane
- Bike Route
- BicyclePA Route G
- - - - Proposed Bike Facility**
- Recommended Bike Corridor*
- Railroad Bed
- North Atherton Street Study Area

- Parks & Preserves
- Municipal Open Space
- State Game Lands
- School District Property
- Penn State Lands
- Municipal Boundary

The Centre Region
 Bicycle Facilities / Existing & Proposed

** Proposed facilities are identified in municipal plans or on municipal Official Maps
 * Recommended Bike Corridors are based on public input

SR 3018 – WHITEHALL RD / UNIVERSITY DR EXT



SR 3018 – WHITEHALL RD / UNIVERSITY DR EXT



SR 3018 – WHITEHALL RD / UNIVERSITY DR EXT



SR 3018 – WHITEHALL RD / UNIVERSITY DR



SR 3018 – WHITEHALL RD / UNIVERSITY DR EXT



SR 3018 – WHITEHALL RD / UNIVERSITY DR EXT



SR 3010 - WARNER BLVD / BOALSBURG RD



SR 3010 - WARNER BLVD / BOALSBURG RD



SR 3010 - WARNER BLVD / BOALSBURG RD



SR 3010 - WARNER BLVD / BOALSBURG RD



SR 3010 - WARNER BLVD / BOALSBURG RD



SR 3010 - WARNER BLVD / BOALSBURG RD



SR 3010 - WARNER BLVD / BOALSBURG RD



SR 3010 - WARNER BLVD / BOALSBURG RD



SR 3010 - WARNER BLVD / BOALSBURG RD







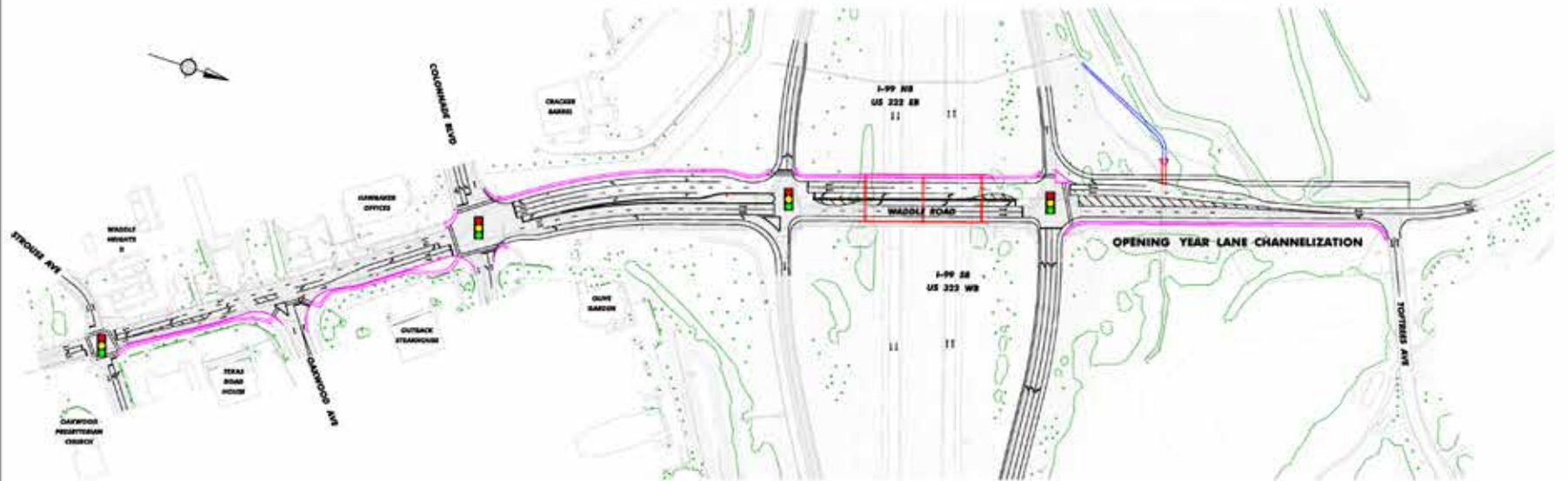

I-99/WADDLE ROAD INTERCHANGE



I-99/WADDLE ROAD INTERCHANGE



LEGEND

- CURBS AND SIDEWALK 
- TRAFFIC SIGNAL 
- BRIDGE & CULVERT 
- TRAFFIC FLOW 
- STREAM RELOCATION 
- UTILITY POLE CONFLICTS 

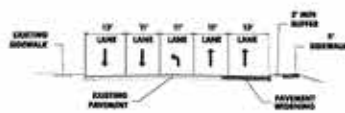

TYPICAL SECTION AT OUTBACK STEAKHOUSE
LOOKING NORTH

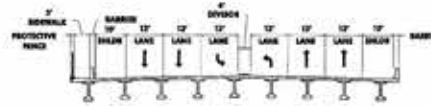

TYPICAL SECTION ON BRIDGE
LOOKING NORTH

WADDLE ROAD INTERCHANGE PROJECT
PATTON TOWNSHIP, CENTRE COUNTY, PENNSYLVANIA

CONVENTIONAL DIAMOND ALTERNATIVE



DECEMBER 21, 2013

I-99/WADDLE ROAD INTERCHANGE



I-99/WADDLE ROAD INTERCHANGE



EDUCATION - 4 FOOT PASS

PLEASE, DON'T SQUEEZE.

MOTORISTS MUST ALLOW BIKES 4 FEET
WHEN PASSING.

IT'S THE LAW.



pennsylvania
DEPARTMENT OF TRANSPORTATION

VARIABLE MESSAGE BOARDS



QUESTIONS?



ACCOMMODATION

FOUR TYPES OF RIDERS

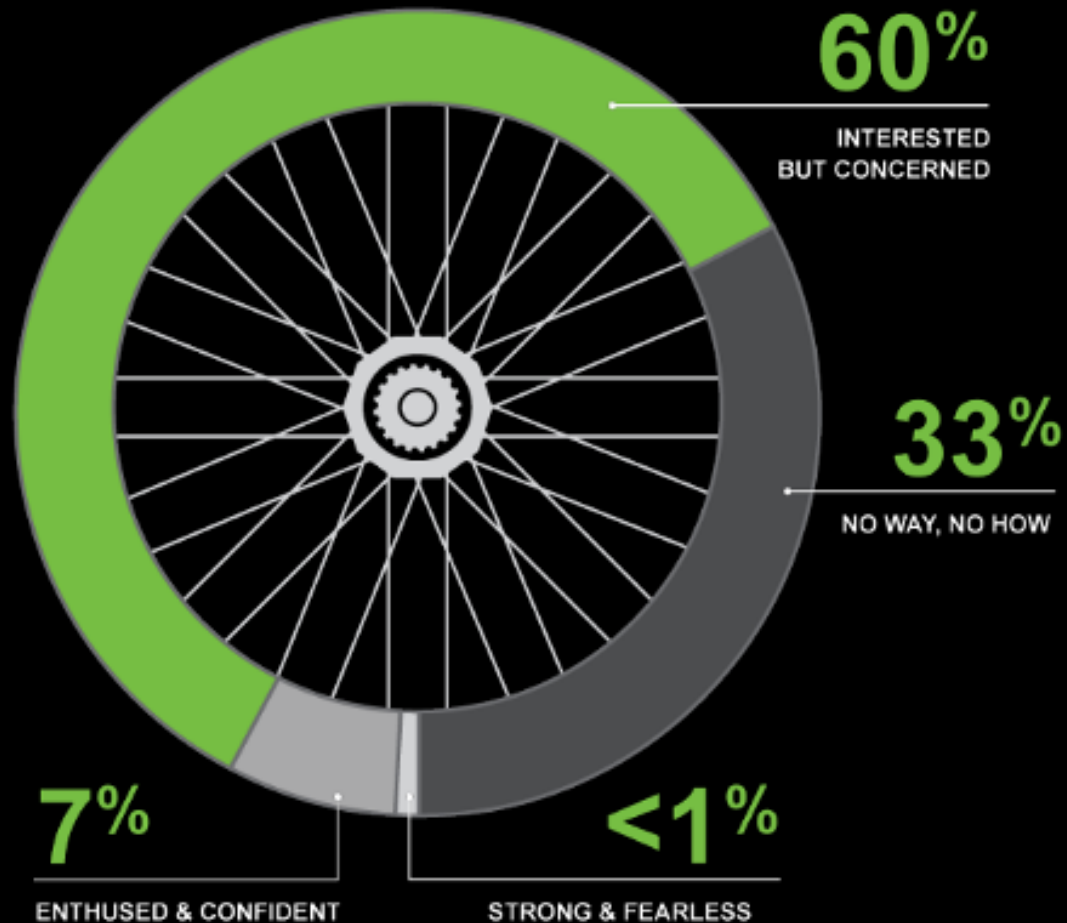

ONLINE MAP

The image is a screenshot of a web browser displaying an online map application. The browser's address bar shows the URL: <https://centrecog.maps.arcgis.com/apps/webappviewer/index.html?id=b9264927503843b1a0c6836b50d99cc0>. The browser's title bar and tabs show the page is titled "Centre Region Bike Map". The browser's menu bar includes "File", "Edit", "View", "Favorites", "Tools", and "Help". The browser's toolbar shows several icons, including "HW Get Paid To Lose Weight...", "Good Morning America o...", "Internet Explorer cannot d...", "Internet Explorer cannot d...", "Suggested Sites", and "Web Slice Gallery".

The map application interface includes a search bar at the top left labeled "Esri World Geocoder". The map itself shows a network of roads and trails in various colors (orange, red, blue, green) around State College, PA. Labels on the map include "State College", "Lemont", and "Boalsburg". The map also shows various landmarks and parks, such as "Perryville State Univ.", "Bryce Jordan Center", "Lemont Marsh Nature Center", "State College Country Club", and "Pine Hill Country Club". The map includes a scale bar at the bottom left showing "0 km" and "40,000, 77,395 Meters". The Esri logo is visible in the bottom right corner of the map area.

The browser's taskbar at the bottom shows several application icons, including the Windows Start button, Internet Explorer, Outlook, File Explorer, Word, Excel, PowerPoint, and a search icon. The system tray at the bottom right shows the system clock indicating "12:10 PM" and "6/27/2016".

EDUCATION



In Pennsylvania the law requires bicyclists...



WEAR a helmet if you are under 12 years of age. This law also applies to children who are passengers in a bike seat or bike trailer.



USE lights between sunset and sunrise. If you ride at night your bike must be equipped with a white front light that illuminates at least 500 feet and a rear facing red reflector that is visible from 500 feet.



PROVIDE an audible signal while passing others on a path or sidewalk. An audible signal can be a bell or you can call out "Passing on your left."



YIELD the right-of-way to pedestrians while riding on a shared use path.

It is against the law to use headphones while riding a bike in Pennsylvania.

Be Respectful of All Users



Keep Right Unless Passing



Wear a Helmet



It's the Law
for Children Under 12

Do Not Block Trail



Use Audible Warnings When Passing



Use Lights When Dark



Safety graphics courtesy of city of Portland, Oregon Bureau of Transportation

EDUCATION



ALL USERS:

Keep right except to pass

Be respectful of all users

Pets must be on a leash

BICYCLISTS:

Under 12 must wear helmet

Use lights when dark

Use audible warnings

when passing



HIGH SCHOOL DRIVER'S EDUCATION

Test Question #3

What is a minimum safe distance for a driver to pass a bicyclist going in the same direction?

A. Two feet.

B. Four feet.

C. Six feet.

D. Fifteen feet or more.



PA LAW:

Pennsylvania requires that the driver of a motor vehicle overtaking a bicycle proceeding in the same direction shall pass to the left of the bicycle within not less than four feet at a careful and prudent reduced speed.

Source: 75 Pa. Cons. Stat. §3303

BIKE REPAIR STATIONS

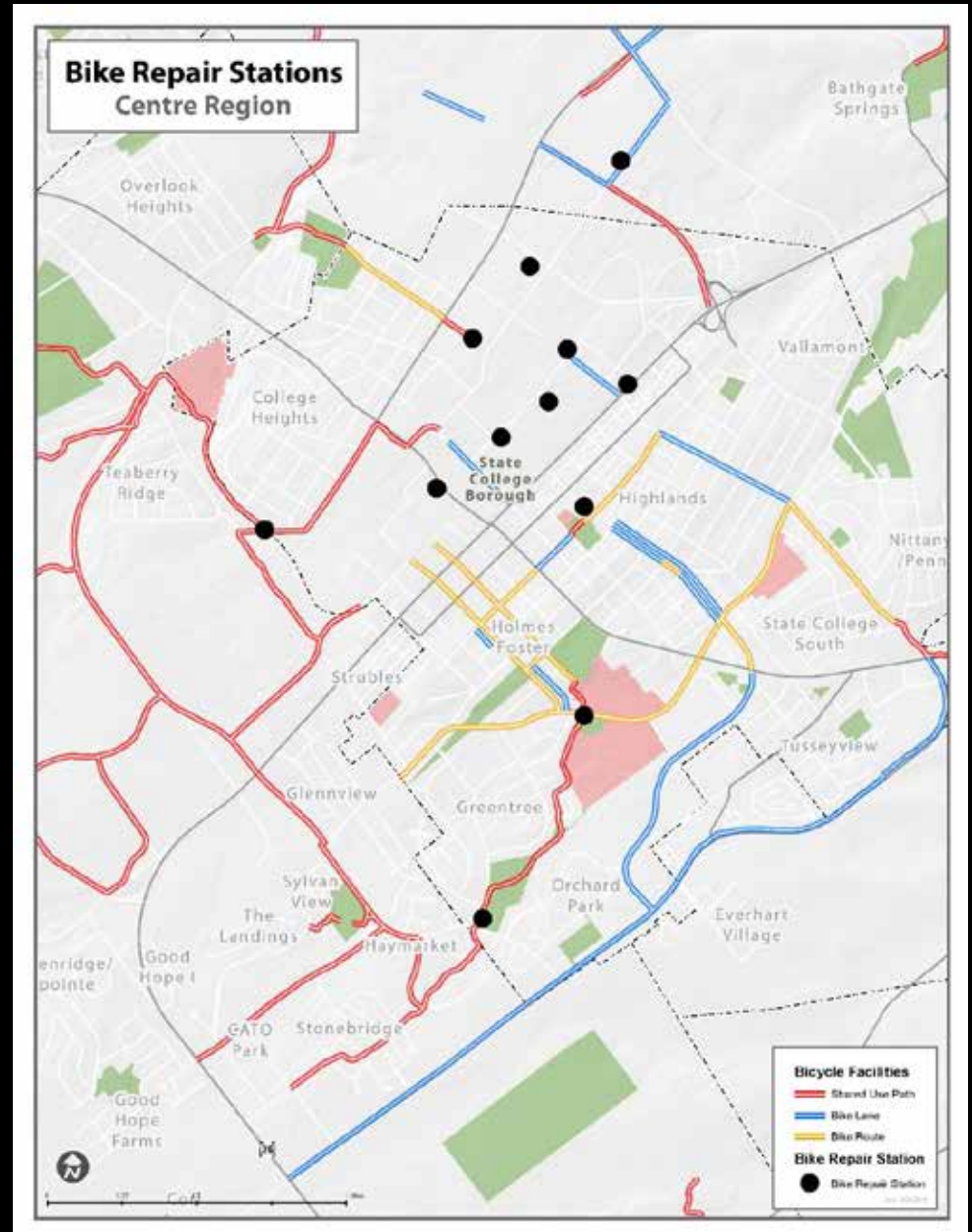

E-BIKE POLICY

Why do people use e-bikes?

Portland State Transportation Research and Education Center

U.S. cities face transportation challenges related to traffic congestion, injury and loss of life from road crashes, local air quality, climate change, obesity and physical inactivity, economic burdens, and international supplies of oil. Shifting people out of cars to other modes of transportation, such as bicycling, can help address these challenges. By overcoming barriers to cycling such as distance, age and disability, e-bikes can help more people cycle and help people cycle more.



60% of respondents indicated that one of the main reasons was because they live or work in a hilly area.



55% of people rode bikes at least weekly before getting an e-bike...

65% said replacing car trips was a main reason to get an e-bike



73% rode an e-bike to a different destination than a standard bike

...93% did after.



People with disabilities rode e-bikes even though 59% had reduced ability to ride a standard bike.

59%



67% said they need a shower after a standard bike trip but...

74% didn't need a shower after an e-bike trip.



BICYCLE FRIENDLY BUSINESSES



THE CENTRE REGION EMPLOYERS' GUIDE TO BIKE TO WORK

How your business can benefit and the steps
to becoming a Bicycle Friendly BusinessSM